

## **A80**

398SAE016EN00

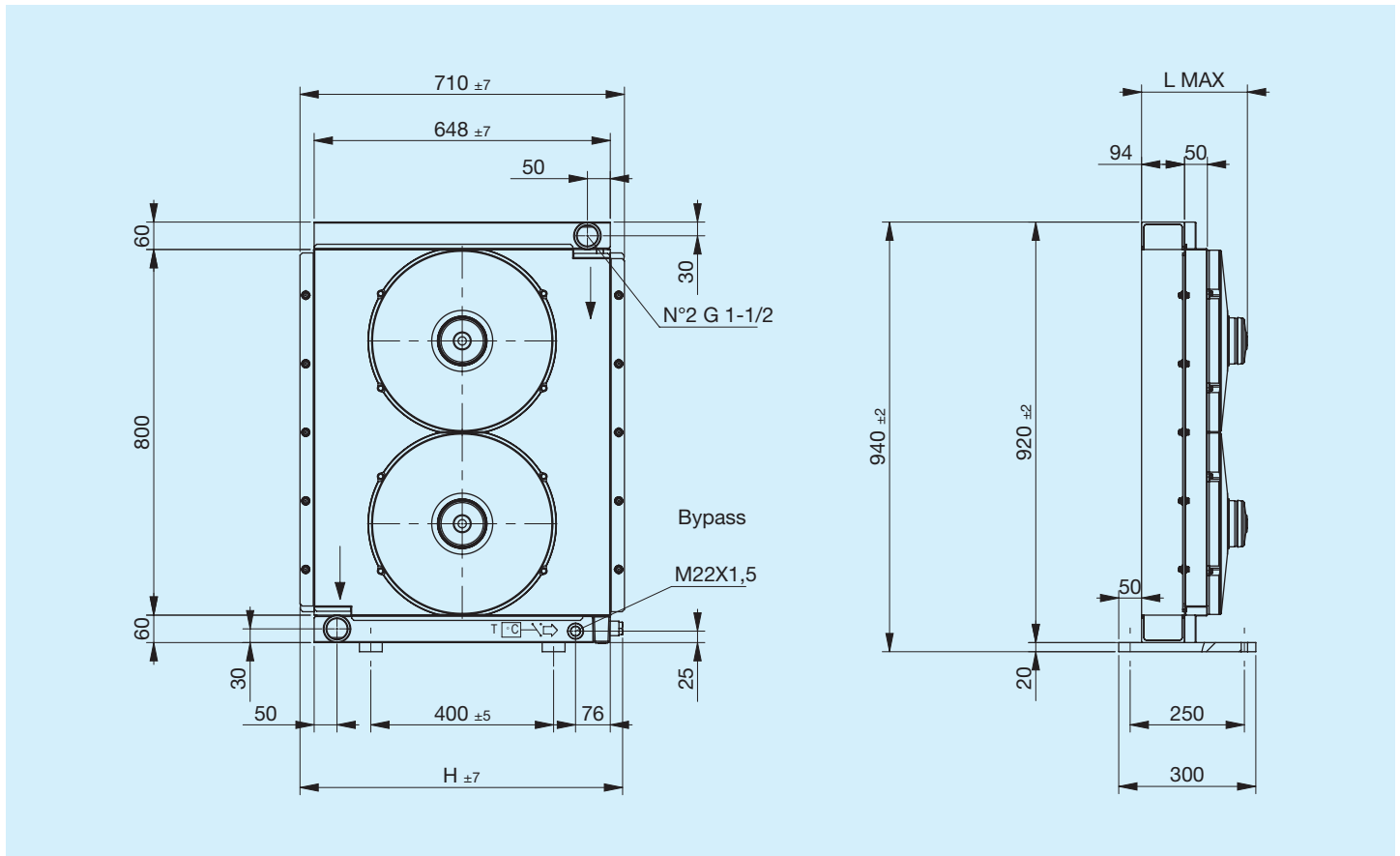

Before using the heat exchanger, carefully read the document entitled GENERAL INSTRUCTIONS FOR HEAT EXCHANGER USE.



Code	Description	Ø Fan mm	Air flow m <sup>3</sup> /h	Voltage V	Amperage A	L Max mm	H mm	Weight Kg	Capacity l
FR633153103	A80 2EAP 12V bypass T15 V.T. 3 bar 60°C	2X385	2X4000	12	2X22	230	706	38	18
FR633153104	A80 2ESP 12V bypass T15 V.T. 3 bar 60°C	2X385	2X4000	12	2X22	230	706	38	18
FR633151003	A80 2EAP 12V bypass T15 VNR 4.5 bar	2X385	2X4000	12	2X22	230	690	38	18
FR633151004	A80 2ESP 12V bypass T15 VNR 4.5 bar	2X385	2X4000	12	2X22	230	690	38	18
FR633153113	A80 2EAP 24V bypass T15 V.T. 3 bar 60°C	2X385	2X4000	24	2X11	230	706	38	18
FR633153114	A80 2ESP 24V bypass T15 V.T. 3 bar 60°C	2X385	2X4000	24	2X11	230	706	38	18
FR633151013	A80 2EAP 24V bypass T15 VNR 4.5 bar	2X385	2X4000	24	2X11	230	690	38	18
FR633151014	A80 2ESP 24V bypass T15 VNR 4.5 bar	2X385	2X4000	24	2X11	230	690	38	18
FR633150003	A80 2EAP 12V	2X385	2X4000	12	2X22	230	710	38	18
FR633150004	A80 2ESP 12V	2X385	2X4000	12	2X22	230	710	38	18
FR633150013	A80 2EAP 24V	2X385	2X4000	24	2X11	230	710	38	18
FR633150014	A80 2ESP 24V	2X385	2X4000	24	2X11	230	710	38	18

## Heat exchange capacity

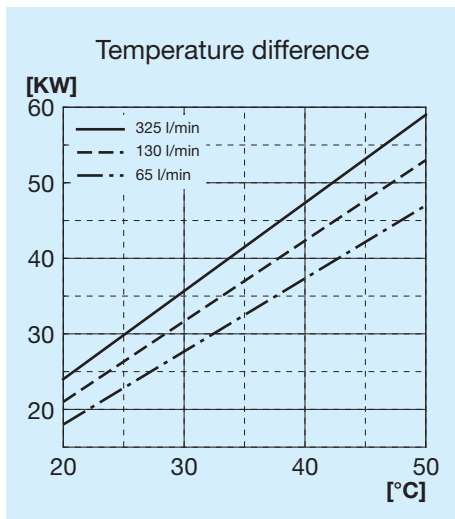

## Radiator passage pressure drop

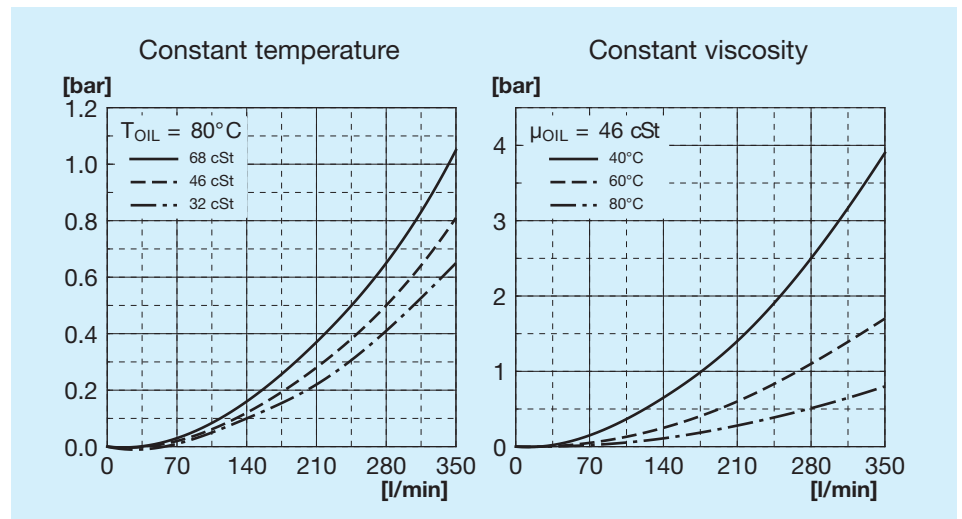

## Bypass passage load loss

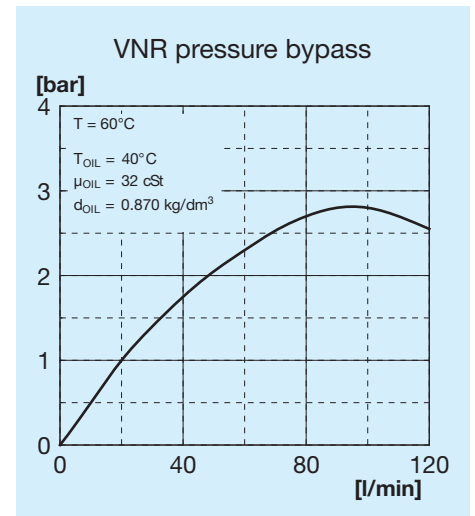
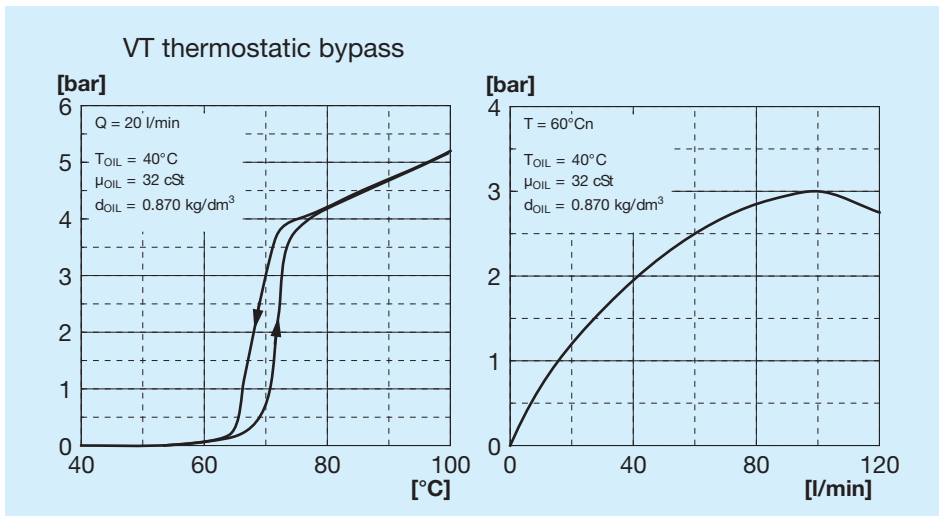

## Bypass valves

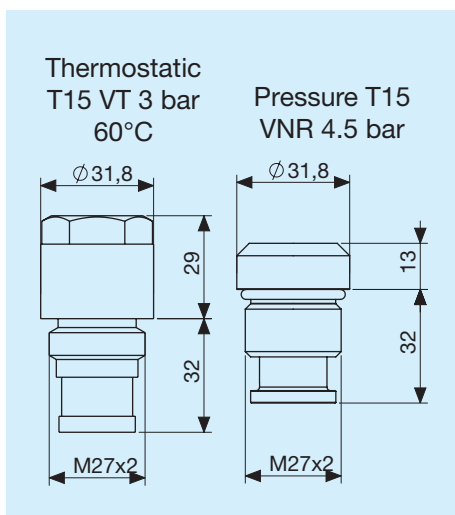

## Legend

A56	Exchanger type
1E	1 Fan unit
AP	High power aspirating
SP	High power blower
AX	Extra high power aspirating
SX	Extra high power blower
12V	Fan unit voltage
24V	Fan unit voltage
T15 VT	Thermostatic bypass valve 3 bar 60°C
T15 VNR	Pressure bypass valve at 4.5 bar

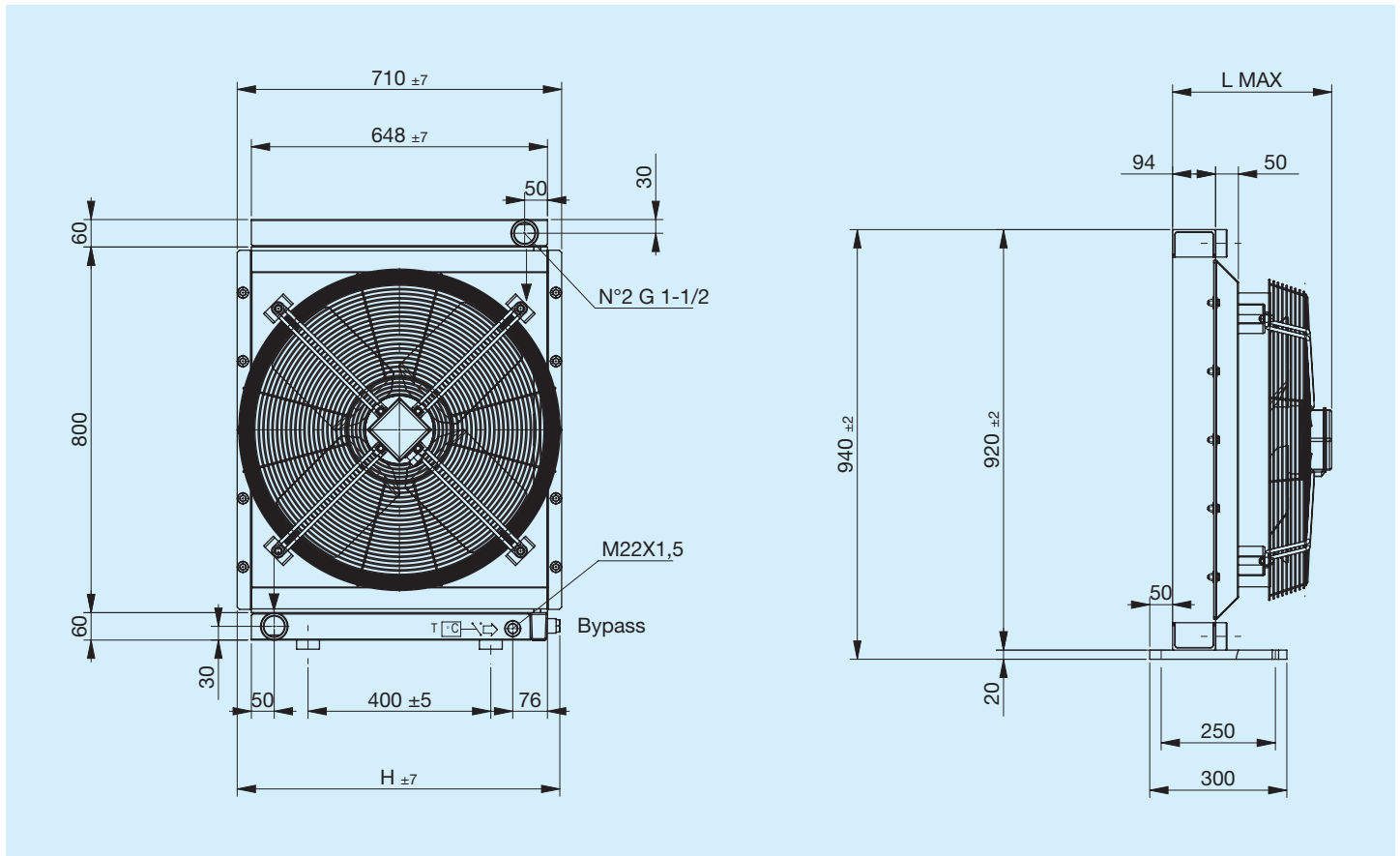

Code	Description	Ø Fan	Power	Frequency	Velocity	IP	L Max	H	Weight	Capacity
		mm	W	Hz	min <sup>-1</sup>	Rating	mm	mm	Kg	l
FR633153131	A80 1EA 230V bypass T15 V.T. 3 bar 60°C	630	600	50	860	54	337	706	45	18
FR633153132	A80 1ES 230V bypass T15 V.T. 3 bar 60°C	630	600	50	860	54	337	706	45	18
FR633151031	A80 1EA 230V bypass T15 VNR. 4.5 bar	630	600	50	860	54	337	690	45	18
FR633151032	A80 1ES 230V bypass T15 VNR. 4.5 bar	630	600	50	860	54	337	690	45	18
FR633153121	A80 1EA 400V bypass T15 V.T. 3 bar 60°C	630	570 920	50 60	900 990	54	337	706	45	18
FR633153122	A80 1ES 400V bypass T15 V.T. 3 bar 60°C	630	640 790	50 60	890 1005	54	337	706	45	18
FR633151021	A80 1EA 400V bypass T15 VNR. 4.5 bar	630	570 920	50 60	900 990	54	337	690	45	18
FR633151022	A80 1ES 400V bypass T15 VNR. 4.5 bar	630	640 790	50 60	890 1005	54	337	690	45	18
FR633150031	A80 1EA 230V	630	600	50	860	54	337	710	45	18
FR633150032	A80 1ES 230V	630	600	50	860	54	337	710	45	18
FR633150021	A80 1EA 400V	630	570 920	50 60	900 990	54	337	710	45	18
FR633150022	A80 1ES 400V	630	640 790	50 60	890 1005	54	337	710	45	18

## Heat exchange capacity

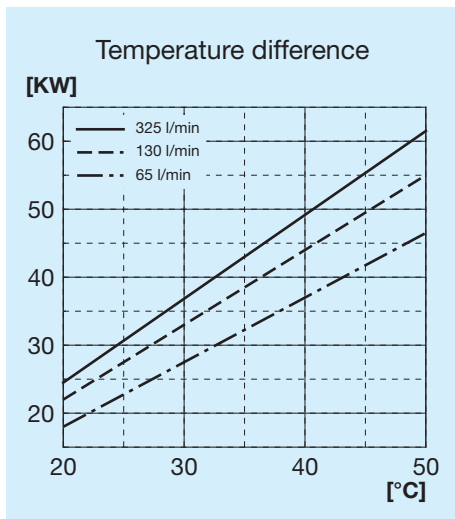

## Radiator passage pressure drop

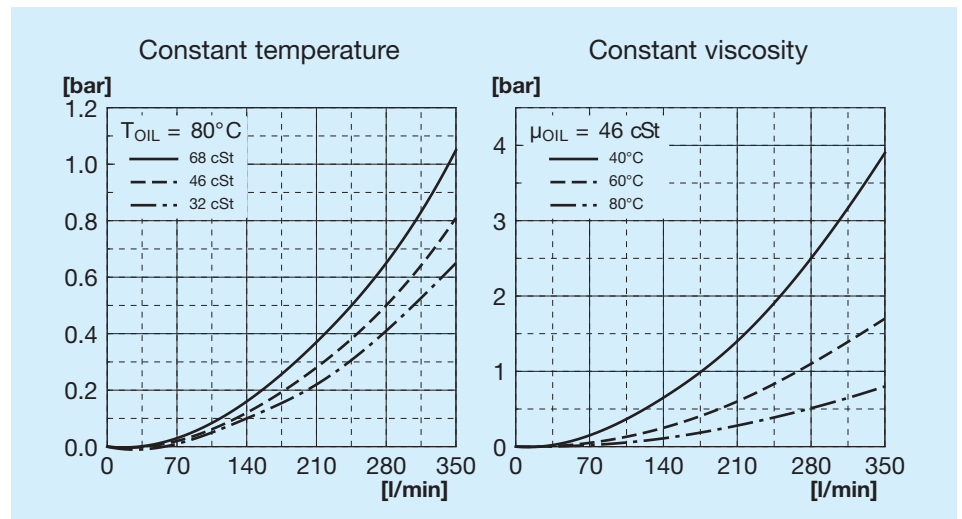

## Bypass passage load loss

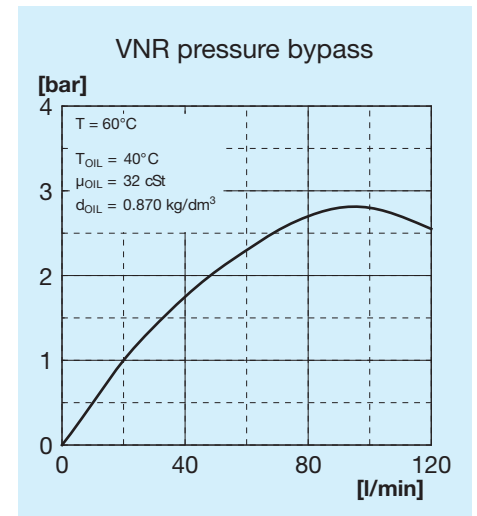
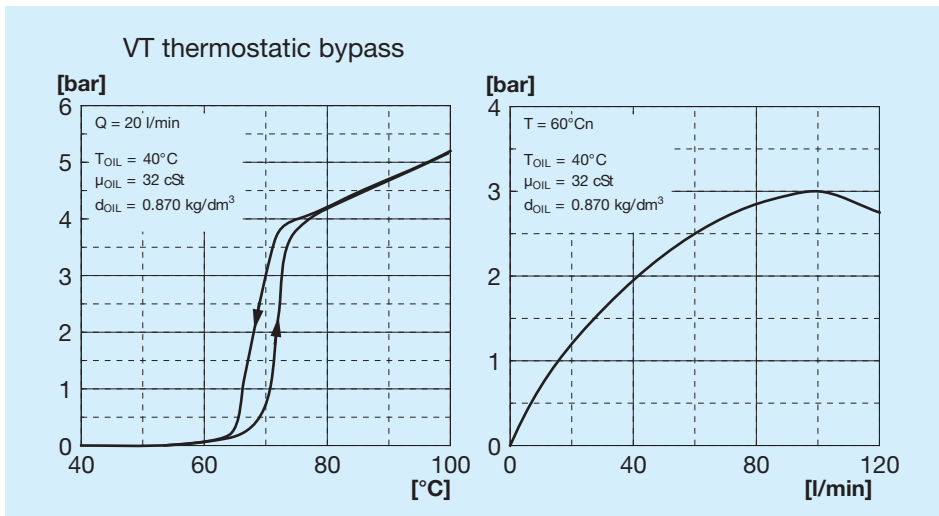

## Bypass valves

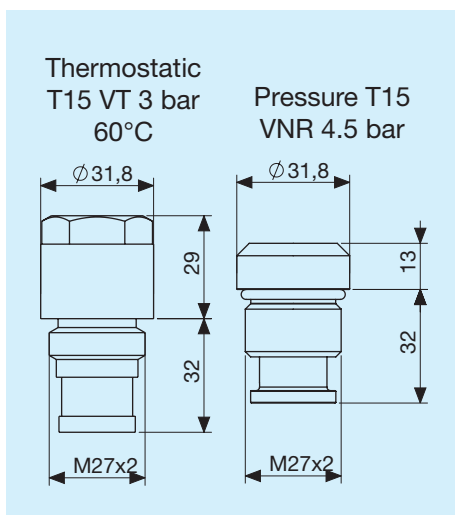

## Legend

A56	Exchanger type
1E	1 Fan unit
AP	High power aspirating
SP	High power blower
AX	Extra high power aspirating
SX	Extra high power blower
12V	Fan unit voltage
24V	Fan unit voltage
T15 VT	Thermostatic bypass valve 3 bar 60°C
T15 VNR	Pressure bypass valve at 4.5 bar

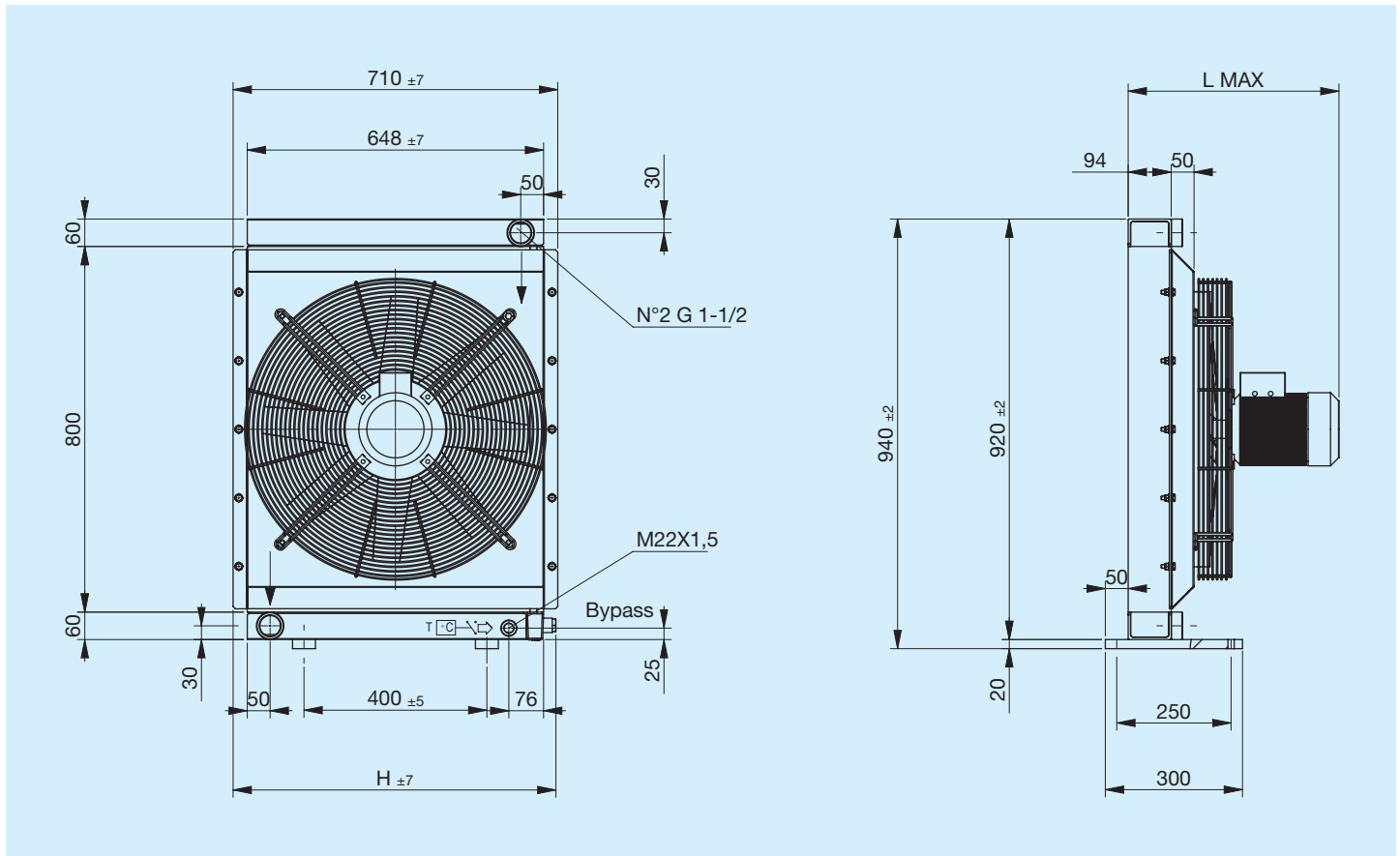

Code	Description	Ø Fan mm	Power W	Frequency Hz	Velocity min <sup>-1</sup>	IP Rating	L Max mm	H mm	Weight Kg	Capacity l
FR633153141	A80 1EA 220V-B14 bypass T15 V.T. 3 bar 60°C	580	750	50	1390	65	458	706	53,5	18
FR633153142	A80 1EA 220V-B14 bypass T15 V.T. 3 bar 60°C	580	750	50	1390	65	458	706	53,5	18
FR633151041	A80 1EA 220V-B14 bypass T15 VNR 4.5 bar	580	750	50	1390	65	458	690	53,5	18
FR633151042	A80 1EA 220V-B14 bypass T15 VNR 4.5 bar	580	750	50	1390	65	458	690	53,5	18
FR633153151	A80 1EA 380V-B14 bypass T15 V.T. 3 bar 60°C	580	750	50	1390	65	458	706	53,5	18
FR633153152	A80 1ES 380V-B14 bypass T15 V.T. 3 bar 60°C	580	750	50	1390	65	458	706	53,5	18
FR633151051	A80 1EA 380V-B14 bypass T15 VNR 4.5 bar	580	750	50	1390	65	458	690	53,5	18
FR633151052	A80 1ES 380V-B14 bypass T15 VNR 4.5 bar	580	750	50	1390	65	458	690	53,5	18
FR633150041	A80 1EA 220V-B14	580	750	50	1390	65	458	710	53,5	18
FR633150042	A80 1ES 220V-B14	580	750	50	1390	65	458	710	53,5	18
FR633150051	A80 1EA 380V-B14	580	750	50	1390	65	458	710	53,5	18
FR633150052	A80 1ES 380V-B14	580	750	50	1390	65	458	710	53,5	18

## Heat exchange capacity

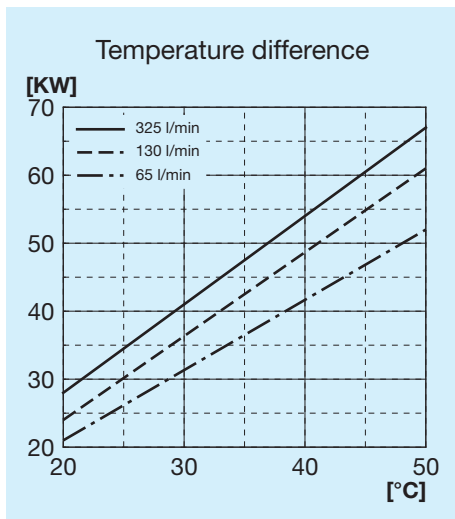

## Radiator passage pressure drop

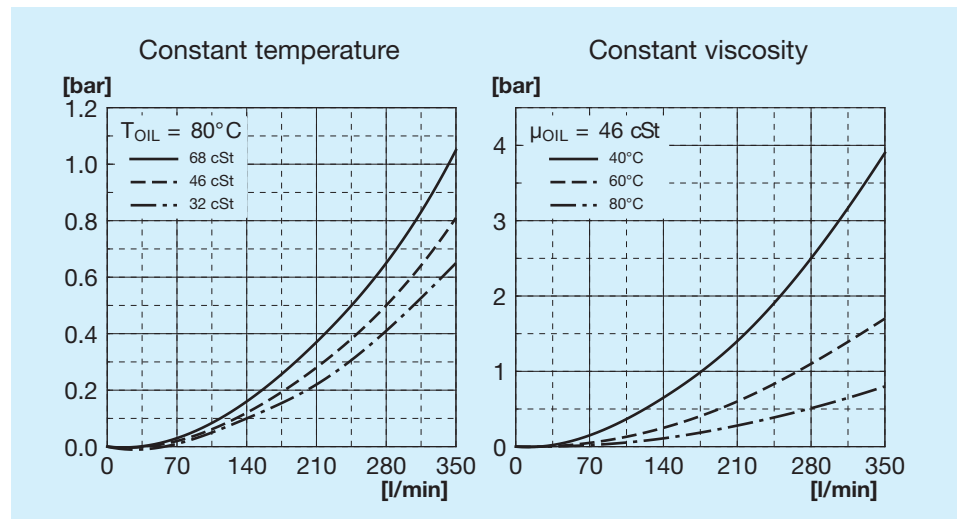

## Bypass passage load loss

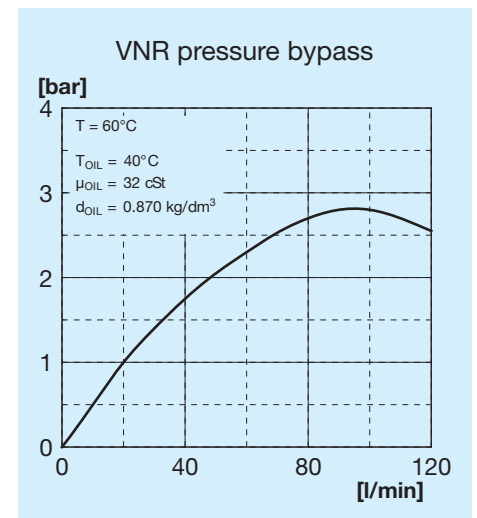
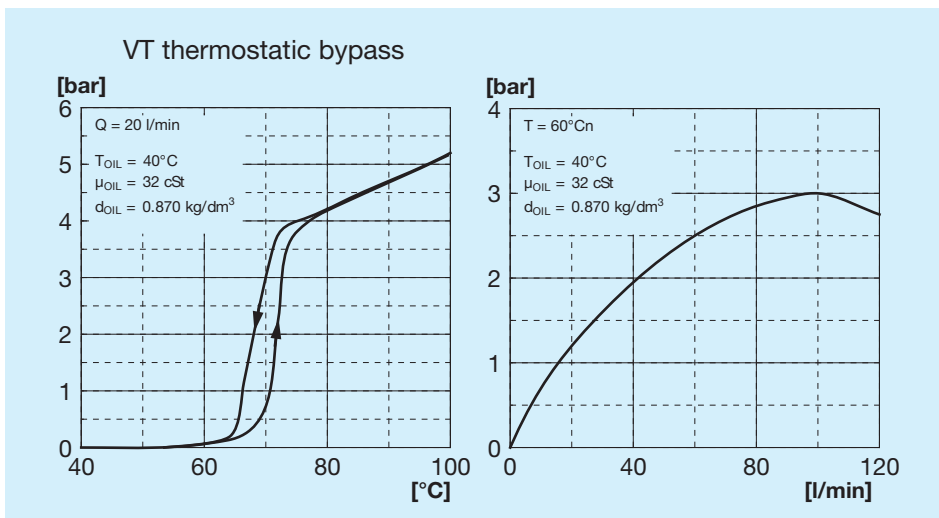

## Bypass valves

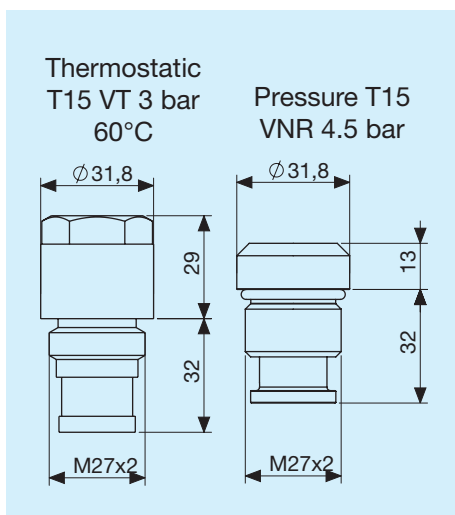

## Legend

A56	Exchanger type
1E	1 Fan unit
AP	High power aspirating
SP	High power blower
AX	Extra high power aspirating
SX	Extra high power blower
12V	Fan unit voltage
24V	Fan unit voltage
T15 VT	Thermostatic bypass valve 3 bar 60°C
T15 VNR	Pressure bypass valve at 4.5 bar

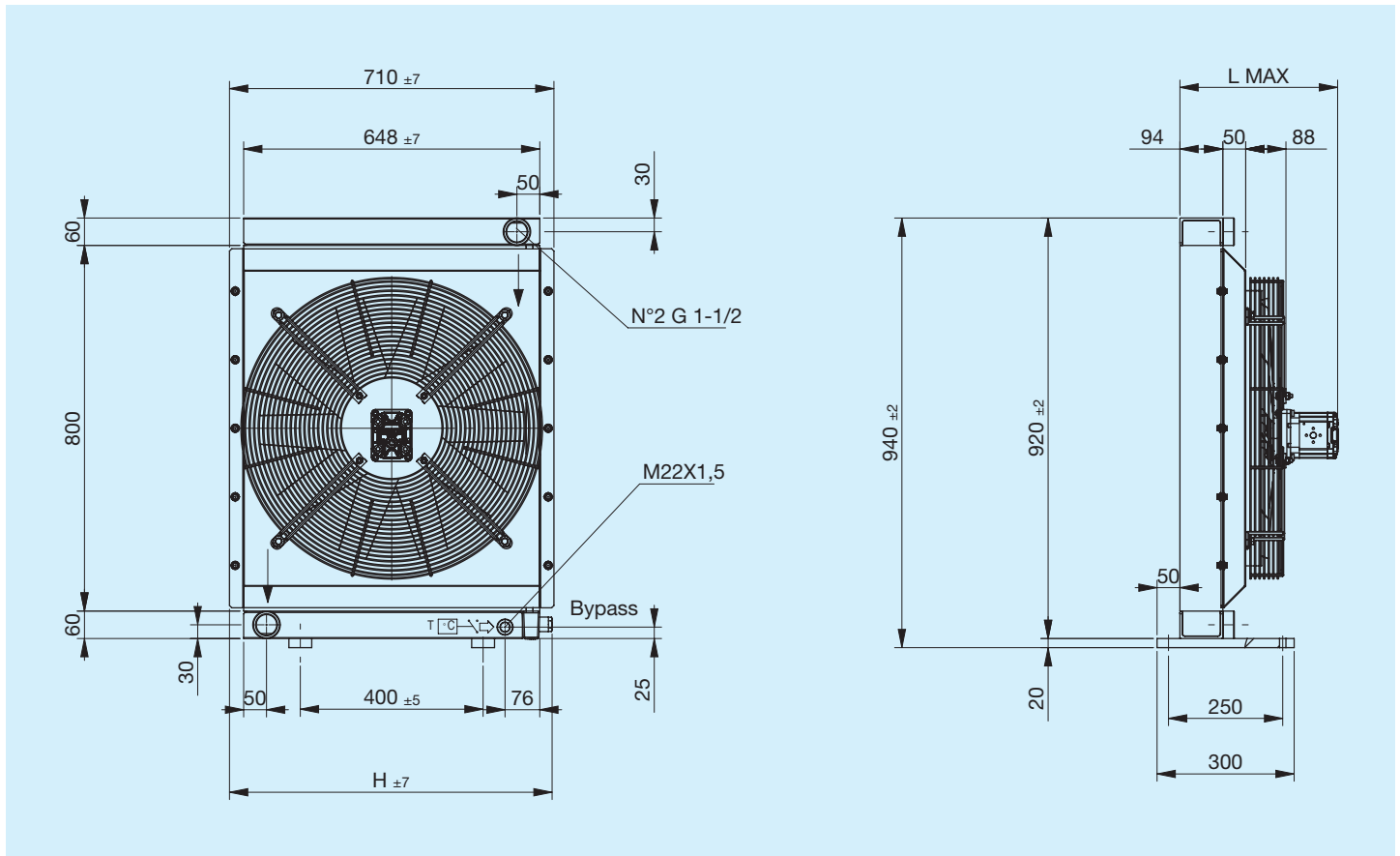

Code	Description	Ø Fan mm	Displacement motors cm <sup>3</sup> /h	L Max mm	H mm	Weight Kg	Capacity l
FR634153103	A80 IA PRED.GR2 bypass T15 V.T. 3 bar 60°C	580	—	280	706	46	18
FR634153104	A80 IS PRED.GR2 bypass T15 V.T. 3 bar 60°C	580	—	280	706	46	18
FR634151003	A80 IA PRED.GR2 bypass T15 VNR 4.5 bar	580	—	280	690	46	18
FR634151004	A80 IS PRED.GR2 bypass T15 VNR 4.5 bar	580	—	280	690	46	18
FR634153113	A80 IA MOT. IDR. GR2 bypass T15 V.T. 3 bar 60°C	580	11	340	706	47	18
FR634153114	A80 IS MOT. IDR. GR2 bypass T15 V.T. 3 bar 60°C	580	11	340	706	47	18
FR634151013	A80 IA MOT. IDR. GR2 bypass T15 VNR 4.5 bar	580	11	340	690	47	18
FR634151014	A80 IS MOT. IDR. GR2 bypass T15 VNR 4.5 bar	580	11	340	690	47	18
FR634150003	A80 IA PRED.GR2	580	—	280	710	46	18
FR634150004	A80 IS PRED.GR2	580	—	280	710	46	18
FR634150013	A80 IA MOT. IDR. GR2	580	11	340	710	47	18
FR634150014	A80 IS MOT. IDR. GR2	580	11	340	710	47	18



## Heat exchange capacity

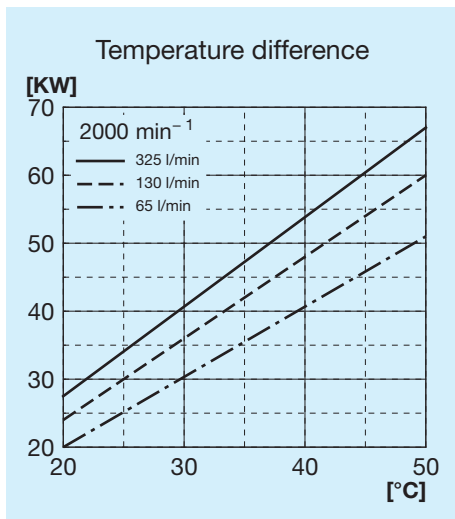

## Radiator passage pressure drop

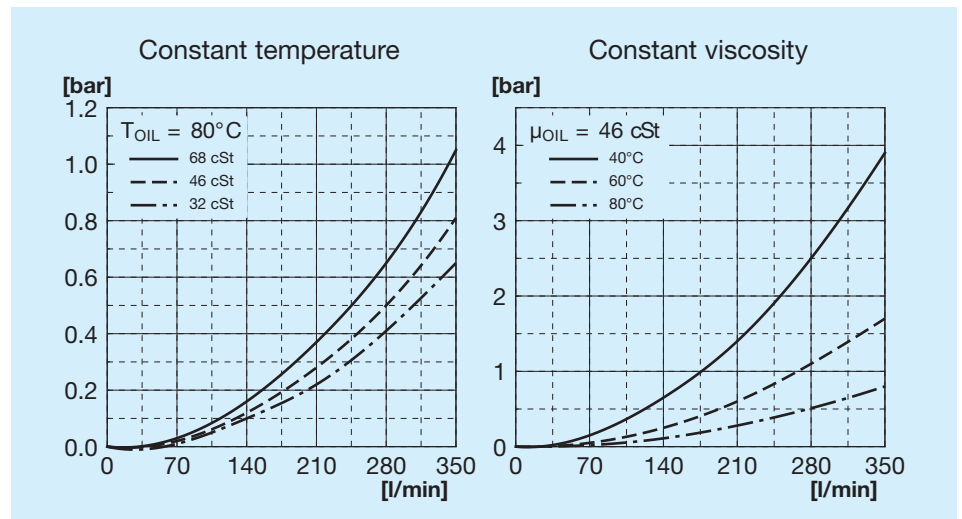

## Bypass passage load loss

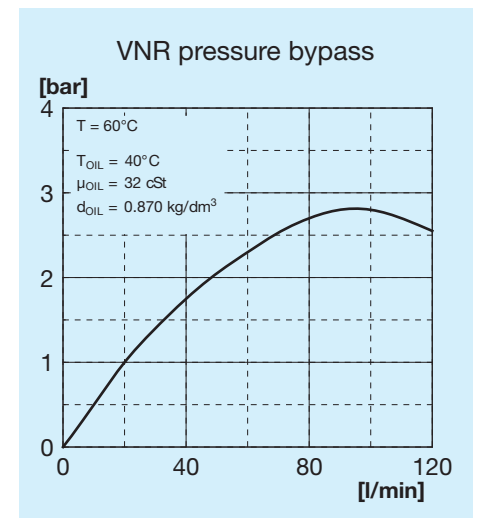
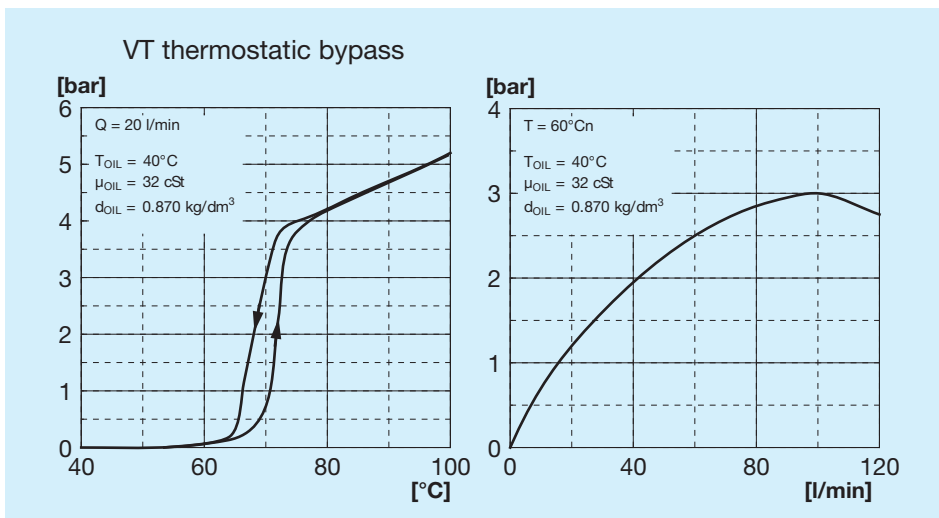

## Bypass valves

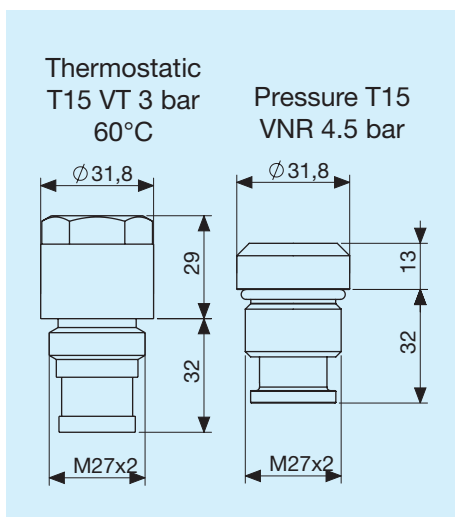

## Legend

A56	Exchanger type
1E	1 Fan unit
AP	High power aspirating
SP	High power blower
AX	Extra high power aspirating
SX	Extra high power blower
12V	Fan unit voltage
24V	Fan unit voltage
T15 VT	Thermostatic bypass valve 3 bar 60°C
T15 VNR	Pressure bypass valve at 4.5 bar

## Connector

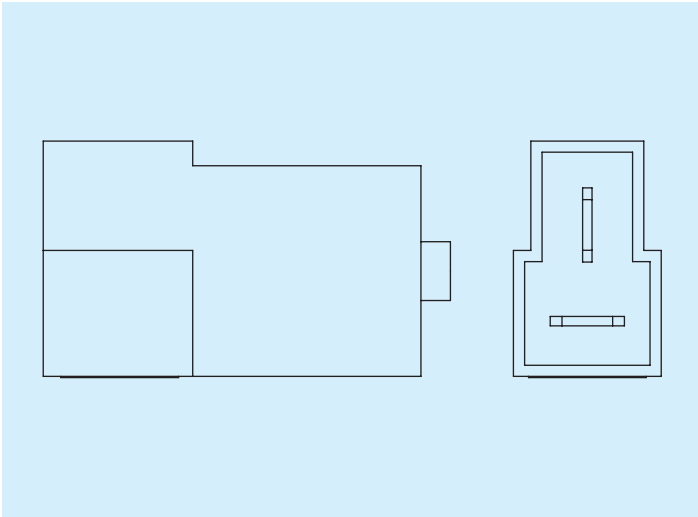

	Code
AMP connector	180908

## Left supporting foot

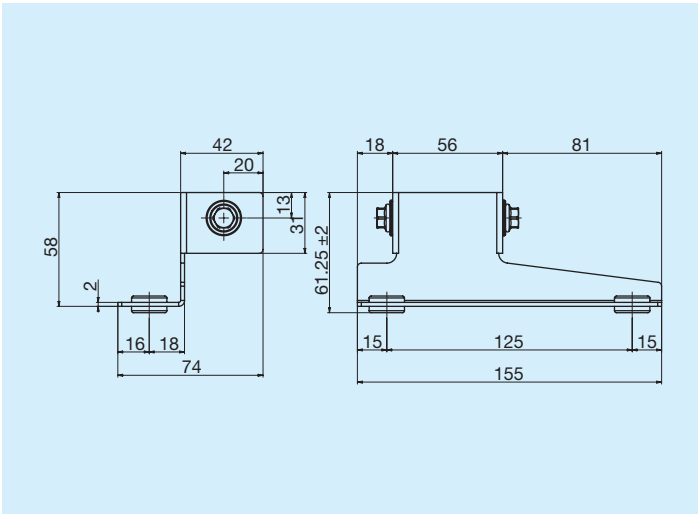

	Code
Left supporting foot	FR29000011

## Right supporting foot

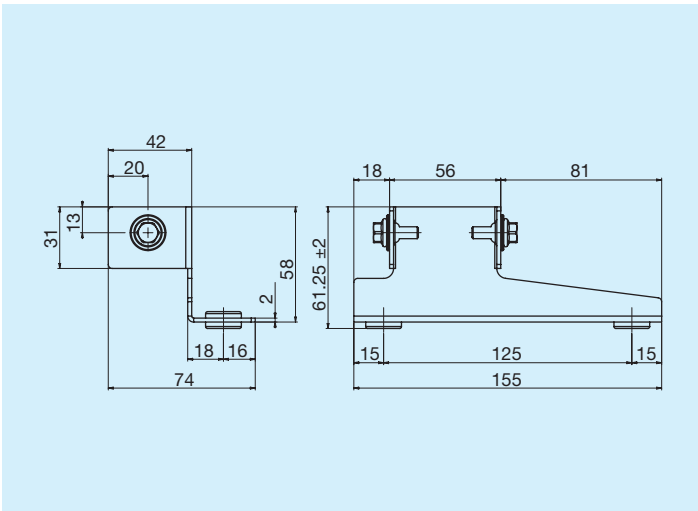

	Code
Right supporting foot	FR29000012

## Thermostats

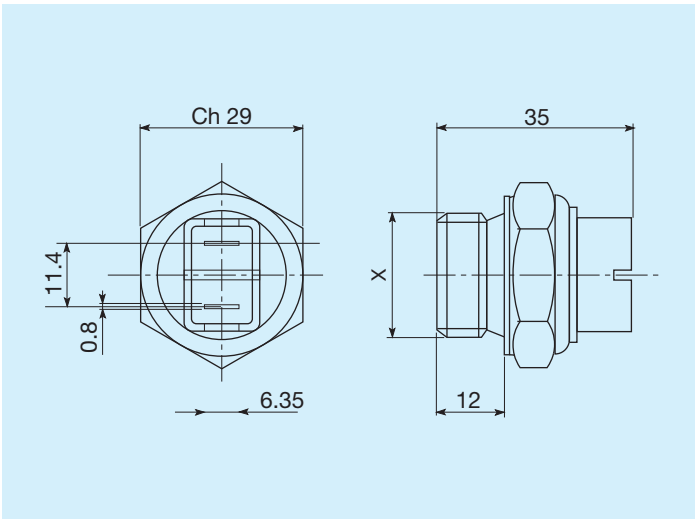

Trigger temperature °C		Code
45 - 35	M22x1.5	FR 361104535
60 - 50	M22x1.5	FR 361106050
80 - 70	M22x1.5	FR 361108070
82 - 68	M22x1.5	FR 361108268
85 - 76	M22x1.5	FR 361108576

## IP54 protected thermal switch

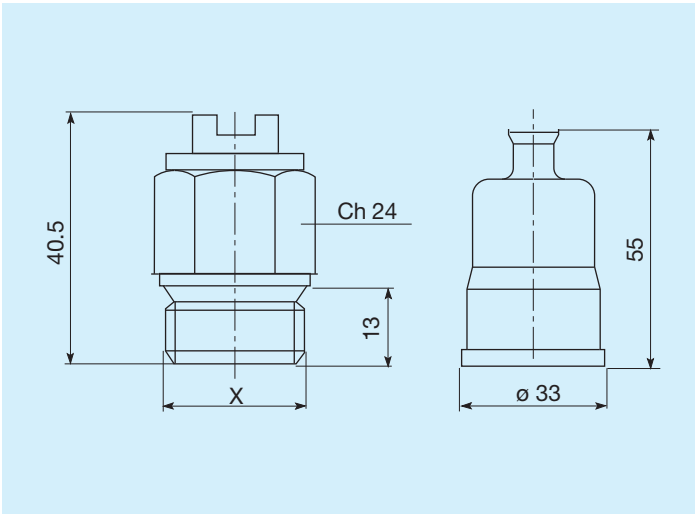

Trigger temperature °C		Code
45 - 35	M22x1.5	FR 361124535
50 - 40	M22x1.5	FR 361125040
60 - 50	M22x1.5	FR 361126050
70 - 60	M22x1.5	FR 361127060
80 - 70	M22x1.5	FR 361128070

## IP65 protected thermal switch

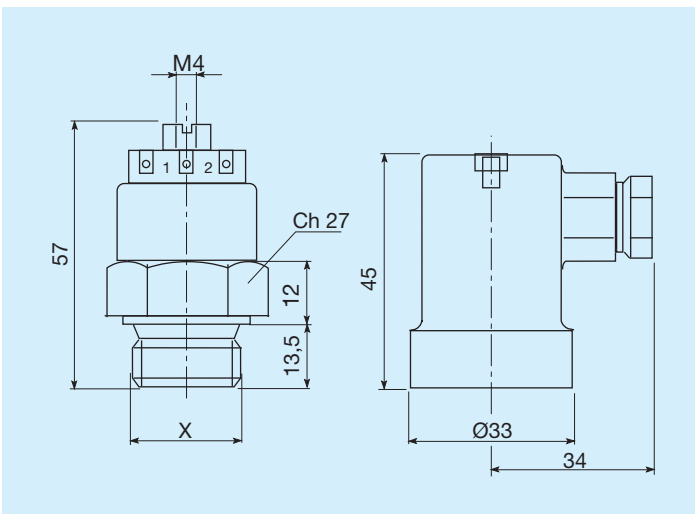

Trigger temperature °C		Code
45 - 35	M22x1.5	FR 361154535
47 - 36	M22x1.5	FR 361155040
60 - 50	M22x1.5	FR 361156050
80 - 70	M22x1.5	FR 361158070