

## A53 ECO

---

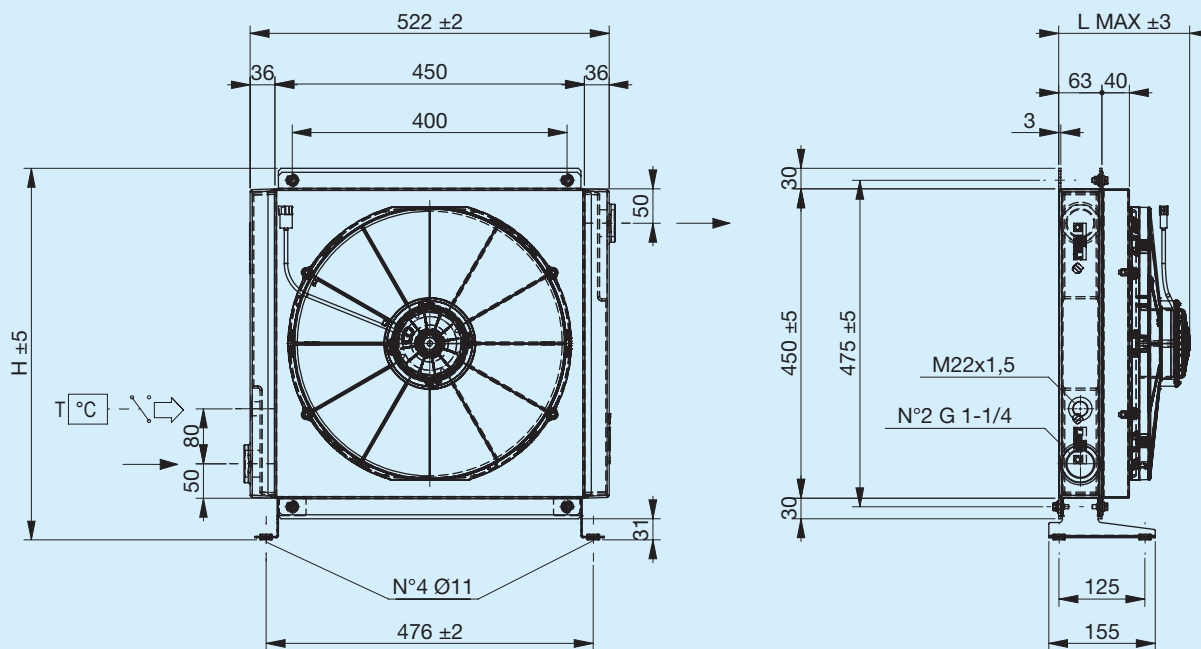

Before using the heat exchanger, carefully read the document entitled GENERAL INSTRUCTIONS FOR HEAT EXCHANGER USE.



Support foot not included (see Accessories)

Code	Description	Ø Fan mm	Air flow rate m <sup>3</sup> /h	Voltage V	Current A	L Max mm	H mm	Weight Kg	Capacity l
FR633190003	A53 1EAP 12V ECO	385	1260	12	7.4	155	541	18	3.5
FR633190004	A53 1ESP 12V ECO	385	1280	12	7	155	541	18	3.5
FR633190005	A53 1EAX 12V ECO	385	2760	12	17.1	191	541	18	3.5
FR633190006	A53 1ESX 12V ECO	385	2960	12	17.7	191	541	18	3.5
FR633190011	A53 1EAP 24V ECO	385	1410	24	4.2	155	541	18	3.5
FR633190012	A53 1ESP 24V ECO	385	1380	24	3.9	155	541	18	3.5
FR633190015	A53 1EAX 24V ECO	385	2930	24	9.2	191	541	18	3.5
FR633190016	A53 1ESX 24V ECO	385	3130	24	9.4	191	541	18	3.5

Heat exchange (thermal) capacity

Radiator passage pressure drop

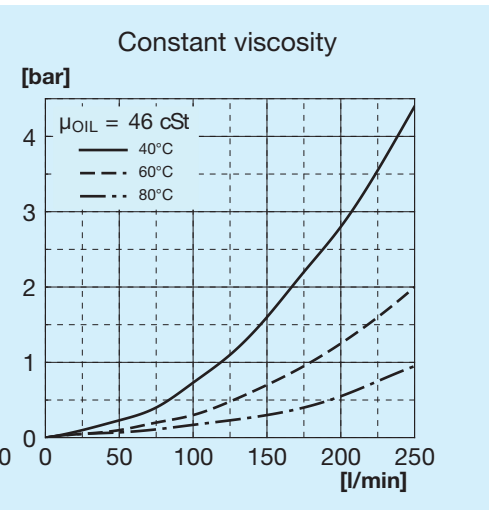
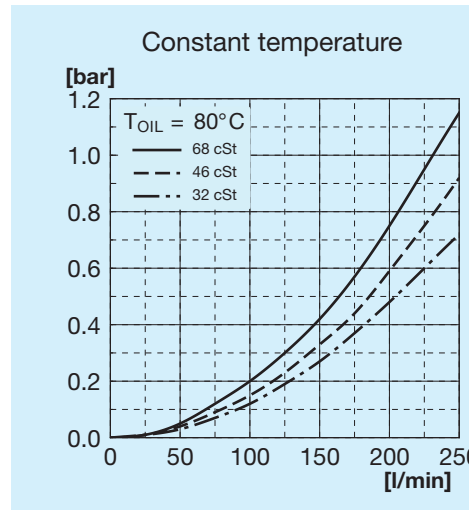
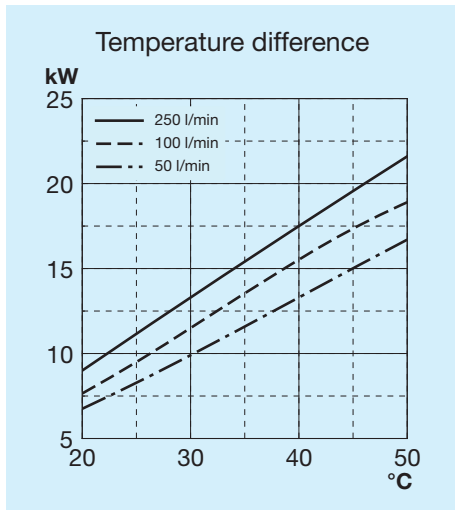

## Legend

A53 ECO	Exchanger type
1E	1 Fan unit
A	Aspirating
S	Blowing
AP	High power aspirating
SP	High power blower
AX	Extra high power aspirating
SX	Extra high power blower
12V	Fan unit voltage
24V	Fan unit voltage

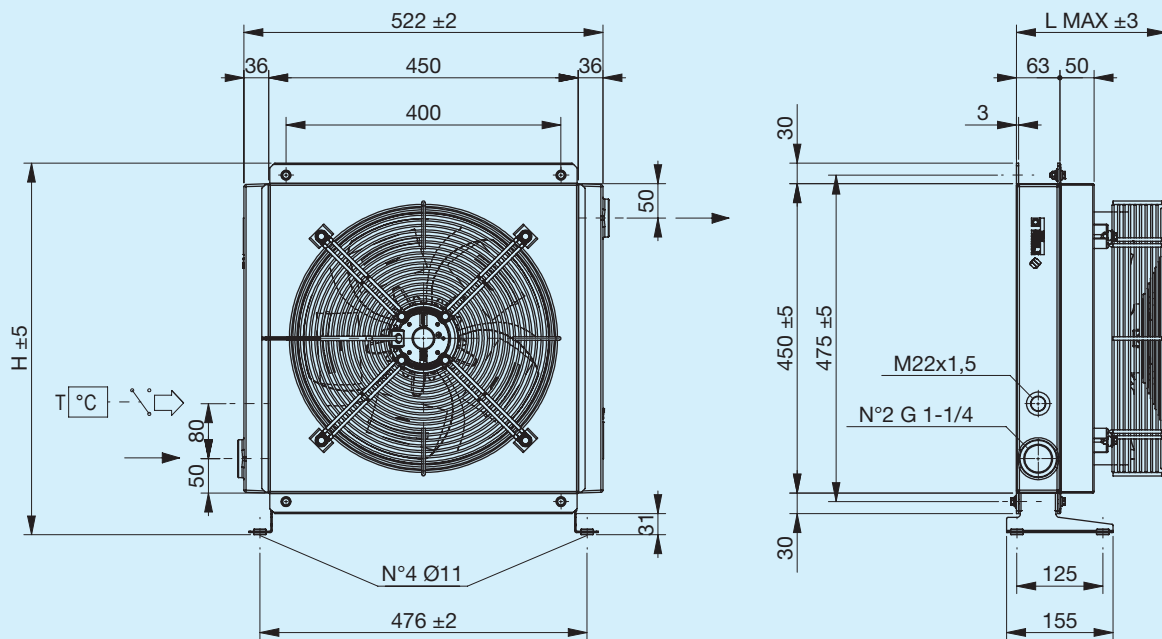

Support foot not included (see Accessories)

Code	Description	Ø Fan mm	Power W	Frequen- cy Hz	Speed min <sup>-1</sup>	Pro- tection IP	L Max mm	H mm	Weight Kg	Capacity l
FR633190031	A53 1EA 230V ECO	350	180	50 60	1365 1530	44	218	541	21	3.5
FR633190032	A53 1ES 230V ECO	350	180	50 60	1365 1530	44	218	541	21	3.5
FR633190021	A53 1EA 400V ECO	350	185	50 60	1420 1620	44	218	541	21	3.5
FR633190022	A53 1ES 400V ECO	350	185	50 60	1420 1620	44	218	541	21	3.5

Heat exchange (thermal) capacity

Radiator passage pressure drop

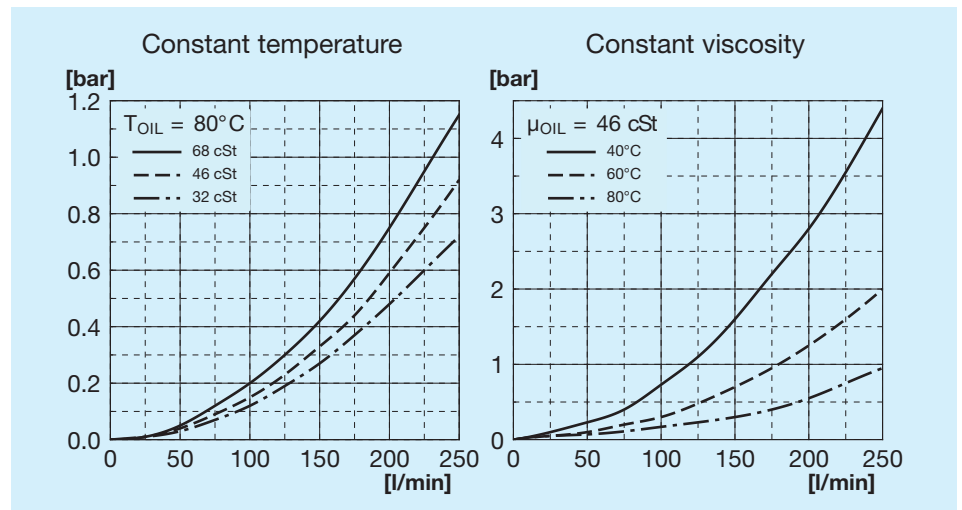
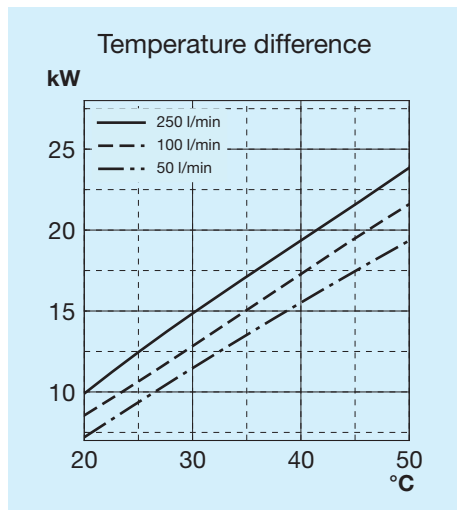

## Legend

A53 ECO	Exchanger type
1E	1 Fan unit
A	Aspirating
S	Blowing
230V	Fan unit voltage
400V	Fan unit voltage

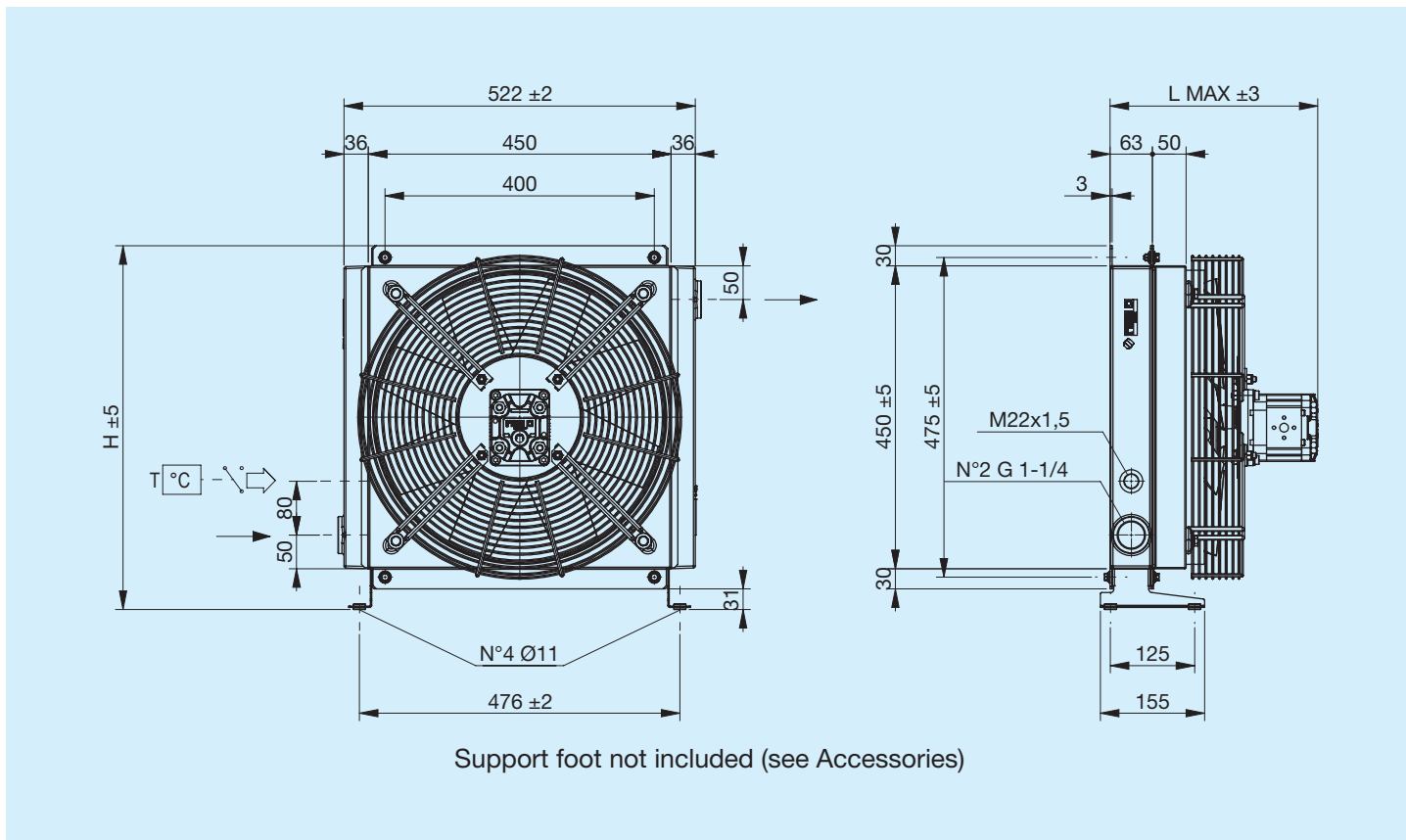

Code	Description	Ø Fan mm	Motor displace- ment cm <sup>3</sup>	L Max mm	H mm	Weight Kg	Capacity l
FR634190003	A53 IA HYDR.MOT. GR2 ECO	420	6	310	541	21	3.5
FR634190004	A53 IS HYDR.MOT. GR2 ECO	420	6	310	541	21	3.5

Heat exchange (thermal) capacity

Radiator passage pressure drop

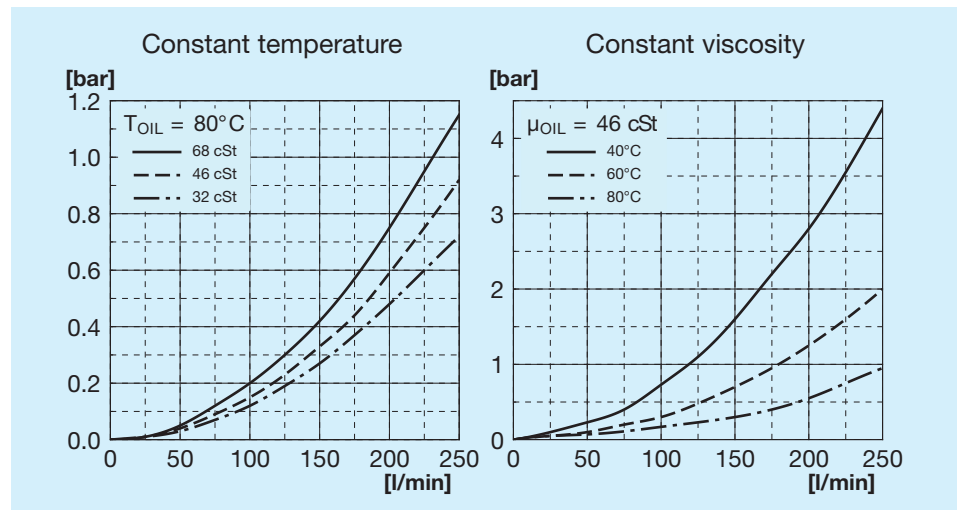
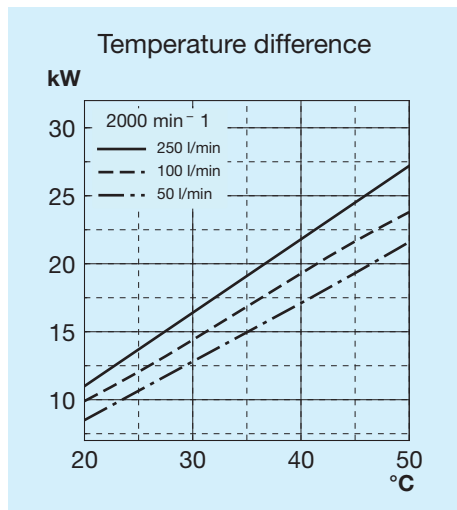

## Legend

A53 ECO	Exchanger type
IA	Hydraulic aspirating
IS	Hydraulic blowing
SETT.	With motor mounting
HYD. MOT.	With integrated motor mounting
GR1	Group 1
GR2	Group 2

## Left supporting foot

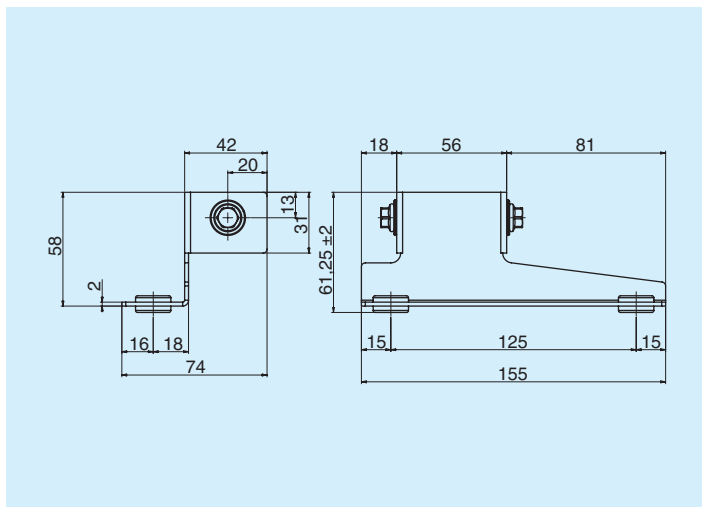

Code	
Left supporting foot	FR290000011R

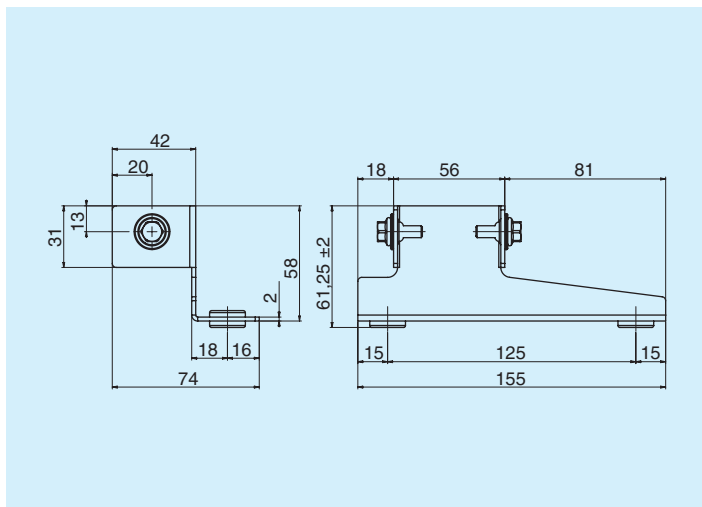

Code	
Right supporting foot	FR290000012R

## Thermostats

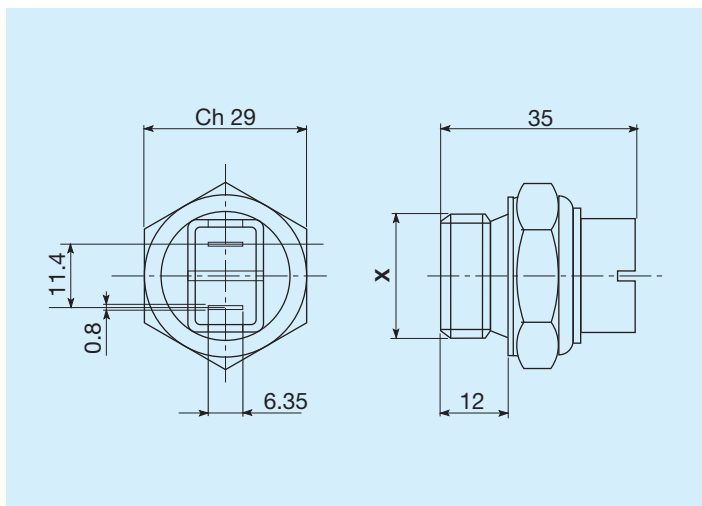

Trigger temperature C°	Threading	Code
45 - 35	M22x1.5	FR361104535R
60 - 50	M22x1.5	FR361106050R
80 - 70	M22x1.5	FR361108070R
82 - 68	M22x1.5	FR361108268R
85 - 76	M22x1.5	FR361108576R



## IP54 protected thermal switch

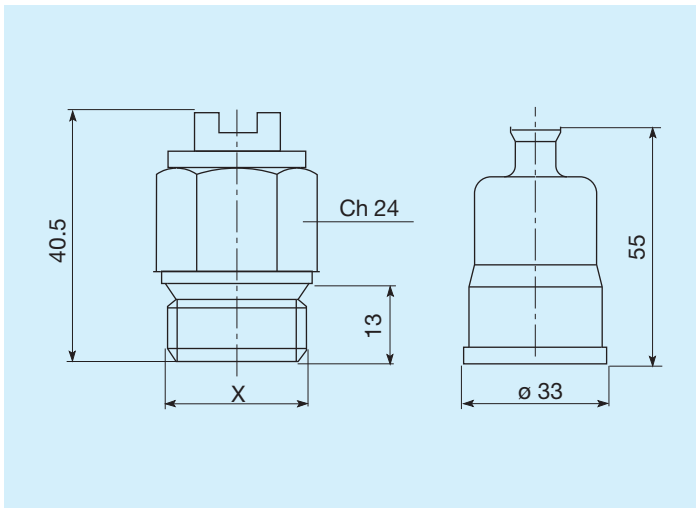

Trigger temperature C°	Threading	Code
45 - 35	M22x1.5	FR361124535R
50 - 40	M22x1.5	FR361125040R
60 - 50	M22x1.5	FR361126050R
70 - 60	M22x1.5	FR361127060R
80 - 70	M22x1.5	FR361128070R

## IP65 protected thermal switch

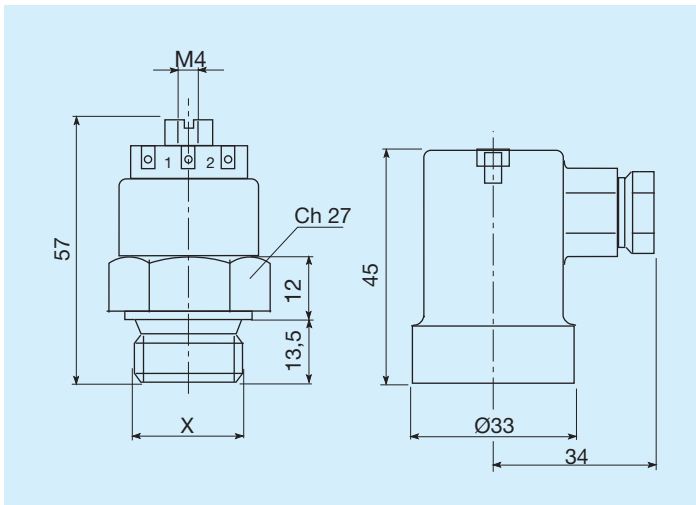

Trigger temperature C°	Threading	Code
45 - 35	M22x1.5	FR361154535R
47 - 36	M22x1.5	FR361155040R
60 - 50	M22x1.5	FR361176050R
80 - 70	M22x1.5	FR361158070R