

**DHZ  
023**



**BONDIOLI  
& PAVESI**   
邦贝 杭州

# China Drivelines catalogue

## DHZ 023

© BONDIOLI & PAVESI SpA

No part of this manual may be reproduced without specific permission from Bondioli & Pavesi.

All data and codes contained in this catalog replace and supersede any information given by previous publications. Consequently data provided in previous publications may no longer be valid. Bondioli & Pavesi reserves the right to change specifications without prior notice or obligation.

---

1. Range.....	4
Size and ratings .....	4
2. Code and dimensions .....	6
Cardan joint driveline.....	6
3. Cross kits.....	9
4. Telescoping members .....	10
5. Driveline length .....	11
6. Safety labels and operator's manuals.....	12
7. Safety shields.....	16
Complete shield kit .....	16
Shield cone configurations.....	17
Code for complete shield kit as spare part .....	18
Spare Parts.....	20
8. Yokes.....	21
RT Ball collar yokes.....	21
Spring pin hole yokes.....	22
Round bore cutter yokes.....	22
Round bore cutter yokes with grease fitting.....	23
Taper pin yokes.....	23
Outer tube yokes .....	24
Inner tube yokes .....	24
9. Overrunning clutches .....	26
RA1 .....	26
RA2 .....	28
10. Shear bolt torque limiters .....	30
LB.....	30
11. Friction torque limiters FFL .....	32
FFL22A.....	32
FFL32A.....	34
FFL42A.....	36
FFL34A.....	38
12. Friction torque limiters FFF .....	40
FFF22A.....	40
FFF32A with push pin .....	42
FFF32A with taper pin.....	44
FFF42A.....	46
FFF34A.....	48
FV44.....	50
13. Lubrication.....	52

# Range

---

Size: 1

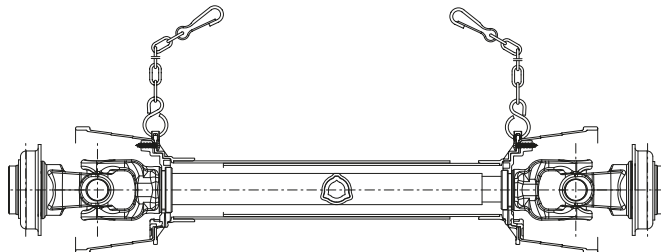

Size: 2 - 4 - 5 - 6

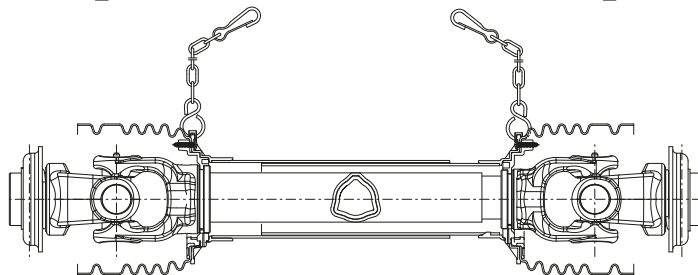

Size: G9

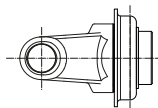
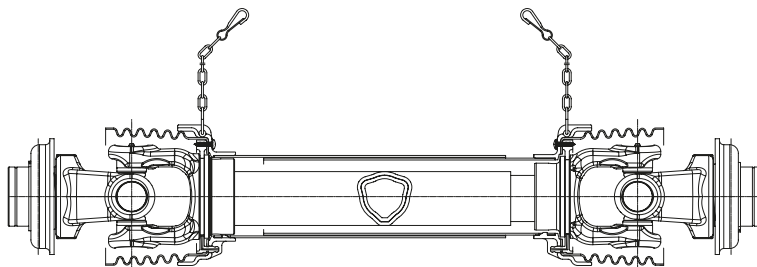
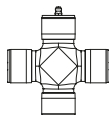

RT Ball collar yokes

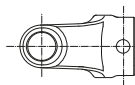

Spring pin hole yokes

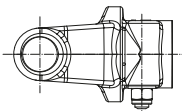

Taper pin yokes

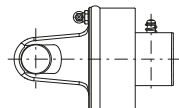

RA  
overrunning clutches

## Size and ratings

Size	Ø mm	H mm	Cross Kit	8 h	540 rpm				1000 rpm				ASAE Classes	
					Pn kW	CV	Mn Nm	in·lb	Pn kW	CV	Mn Nm	in·lb	RD	HD
<b>1</b>	22,0	54,0	BP China	8 h	10	14	180	1600	15	21	146	1300		
<b>2</b>	23,8	61,3	BP Italy	50 h	15	21	270	2400	23	31	220	1950	2	1
			BP China	8 h	13	17	220	1950	18	25	178	1600		
<b>4</b>	27,0	74,6	BP Italy	50 h	26	35	460	4050	40	55	380	3350	3	3
			BP China	8 h	23	31	405	3600	35	47	334	2950		
<b>5</b>	30,2	79,4	BP Italy	50 h	35	47	620	5500	54	74	520	4600	4	3
			BP China	8 h	30	41	530	4700	46	63	442	3900		
<b>6</b>	30,2	91,4	BP Italy	50 h	47	64	830	7350	74	100	710	6250	4	4
			BP China	8 h	38	54	705	6250	63	86	604	5350		
<b>G9</b>	34,9	106,0	BP Italy	50 h	70	95	1240	10950	110	150	1050	9300	6	5

Pn : Nominal power defined as the power associated with a 1000 hours lifetime of a joint operating joint angle 5° at 540 and 1000 rpm.  
Mn : Nominal torque corresponding to the nominal power Pn..

Size	RT ball collar yoke	Spring pin yoke	Taper pin yoke	RA	LB	FFL	FFF	FV
				Max torque	Setting [Nm]	Setting [Nm]	Setting [Nm]	Setting [Nm]
<b>1</b>	1 3/8"	--	--	--	--	--	--	--
<b>2</b>	1 3/8" D8x32x38	--	--	2400	950	--	--	--
<b>4</b>	1 3/8" D8x32x38	Ø 30 mm Ø 35 mm	--	2400	from 1400 to 2000	from 450 to 1050	from 600 to 900	--
<b>5</b>	1 3/8" D8x32x38	Ø 30 mm Ø 35 mm	--	2400	from 2100 to 2400	from 900 to 1100	from 900 to 1100	--
<b>6</b>	1 3/8" - 1 3/4" D8x32x38 D8x42x48	Ø 35 mm	--	3800	from 2400 to 2700	from 900 to 1450	from 900 to 1450	--
<b>G9</b>	1 3/8" - 1 3/4" D8x32x38 D8x42x48	--	1 3/8" 1 3/4"	--	3000	--	--	2200

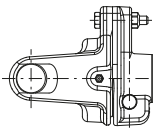

**LB**  
shear bolt clutches

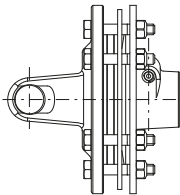

**FFL**  
friction clutches

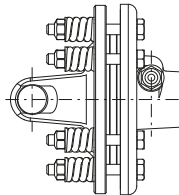

**FFF**  
friction clutches

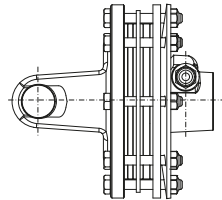

**FV**  
friction clutches

# Code and dimensions

## Cardan joint driveline

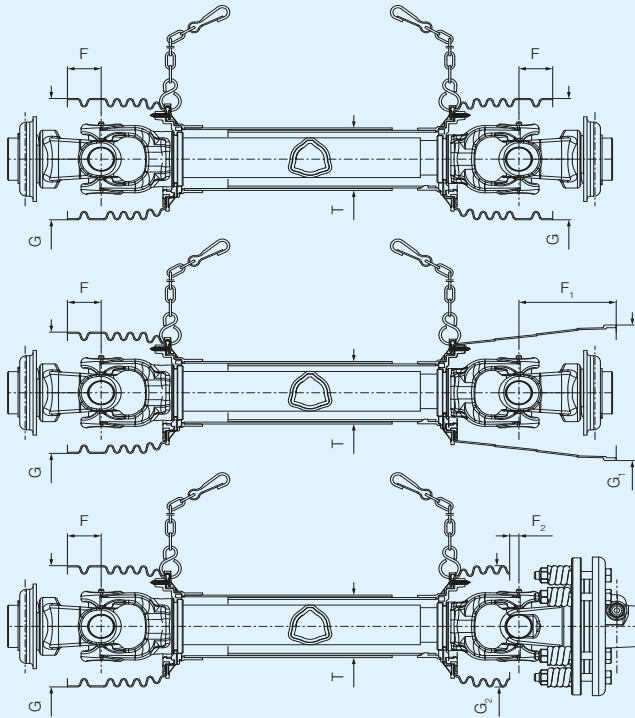

Size 1

Sizes 2 to 6

Size G9

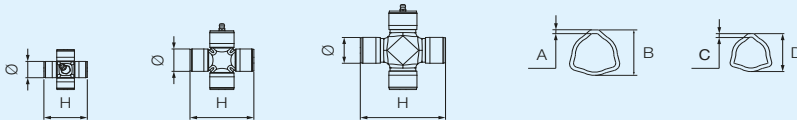

Size	Ø	H	A	B	C	D	G	F	T	G <sub>1</sub>	F <sub>1</sub>	G <sub>2</sub>	F <sub>2</sub>
	mm	mm	mm	mm	mm	mm	mm	mm	mm	mm	mm	mm	mm
<b>1</b>	22,0	54,0	2,6	32,5	4,0	26,5	132	23	61	141	92	--	--
<b>2</b>	23,8	61,3	3,2	36,0	4,0	29,0	127	20	61	141	89	--	--
<b>4</b>	27,0	74,6	3,4	43,5	4,0	36,0	137	24	67	143	96	137	19
<b>5</b>	30,2	79,4	3,0	51,5	4,0	44,8	158	33	81	176	116	158	11
<b>6</b>	30,2	91,4	4,0	54,0	4,0	44,8	158	26	81	176	109	158	18
<b>G9</b>	34,9	106,0	4,0	63,0	4,0	54,0	160	30	96	--	--	--	--

# Code and dimensions

## Code for cardan joint drivelines sizes 1 to 6

Size G9 - see next page

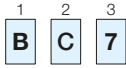

**BC7** : Standard driveline.



**Cross Kit**

**1** - Bondioli & Pavesi Italy.

**2** - Bondioli & Pavesi China.



**Telescoping members**

Normal triangular tubes.



**Size**

**1 - 2 - 4 - 5 - 6**

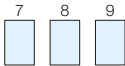

**Length**

**041 - 046 - 051 - 056 - 061 - 066 - 071 - 076 - 081 - 086 - 091 - 101 - 111 - 121**

See page 11 "Length".



**Safety labels and instruction manuals and restraint chains**

**CE** - Drivelines with CE and UKCA mark.

**CU** - Drivelines with CE, UKCA mark and both CE, UKCA and US labels.

**US** - Drivelines for North America (USA, Canada, Mexico), without restraint chains.

**UC** - Drivelines for North America (USA, Canada, Mexico), with restraint chains.

**JP** - Drivelines for Japan.

**FX** - Drivelines for other countries or CEE-EFTA countries not bearing CE mark

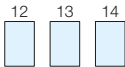

**Driver (or tractor) end**

Specify the three-digit code for the yoke.

See specifications for the selected driveline size.



**Driven (or implement) end**

Specify the three-digit code for the yoke, torque limiter or clutch.

See specifications for the selected driveline size.



**Optional position**

Add to code the letter "**N**" to require optional extended cone on driven end.

Add an "**X**" letter at the end of the code for drive shaft running at 1000 min<sup>-1</sup>.

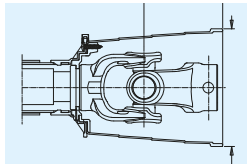

All rotating parts must be guarded. The shields on the tractor and on the implement work with the integral driveline guard to form an interactive guarding system.

For primary drivelines (i.e. the driveline connecting the tractor PTO to the initial power input connection on the implement), torque limiters or overrunning clutches must be fitted on the implement end of the driveline.



# Code and dimensions

## Code for cardan joint drivelines size G9

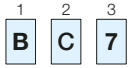

**BC7** : Standard driveline.



Size  
**G9**



Telescoping members  
Normal triangular tubes.

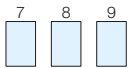

Length

**041 - 046 - 051 - 056 - 061 - 066 - 071 - 076 - 081 - 086 - 091 - 101 - 111 - 121**  
See page 11 "Length".



Safety labels and instruction manuals and restraint chains

**CE** - Drivelines with CE and UKCA mark.

**CU** - Drivelines with CE, UKCA mark and both CE, UKCA and US labels.

**US** - Drivelines for North America (USA, Canada, Mexico), without restraint chains.

**U2** - Drivelines for North America (USA, Canada, Mexico), with restraint chains.

**JP** - Drivelines for Japan.

**FX** - Drivelines for other countries or CEE-EFTA countries not bearing CE mark

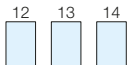

Driver (or tractor) end

Specify the three-digit code for the yoke.

See specifications for the selected driveline size.

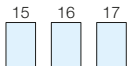

Driven (or implement) end

Specify the three-digit code for the yoke, torque limiter or clutch.

See specifications for the selected driveline size.



Optional position

Add an "X" letter at the end of the code for drive shaft running at 1000 min<sup>-1</sup>.



All rotating parts must be guarded. The shields on the tractor and on the implement work with the integral driveline guard to form an interactive guarding system.

For primary drivelines (i.e. the driveline connecting the tractor PTO to the initial power input connection on the implement), torque limiters or overrunning clutches must be fitted on the implement end of the driveline.

# Cross kits

The codes refer to the cross kit as a spare part - complete with the four snap rings required for assembly. They are supplied in single item or multiple item packs. The pack quantity is indicated by the numbers following the "R" in the code.

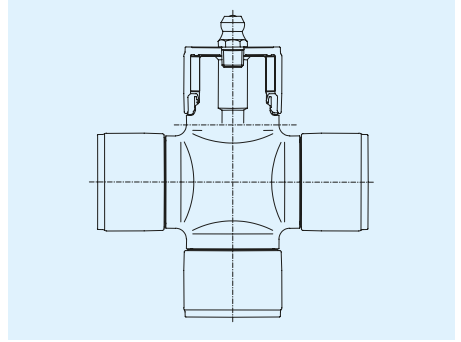

## Cross kits with grease fitting on bearing

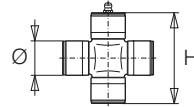

	Bondioli & Pavesi Italy bearings				Bondioli & Pavesi China bearings	
	Ø mm	H mm	Cross Kit Code	Multiple-item pack code	Cross Kit Code	Multiple-item pack code
<b>1</b>	22,0	54,0	--	--	--	--
<b>2</b>	23,8	61,3	4120C0012	4120C0012R30	41202A006A	41202A006AR30
<b>4</b>	27,0	74,6	4120E0012	4120E0012R25	41204A006A	41204A006AR25
<b>5</b>	30,2	79,4	4120G0012	4120G0012R40	41205A006A	41205A006AR40
<b>6</b>	30,2	91,4	4120H0012	4120H0012R30	41206A006A	41206A006AR30
<b>G9</b>	34,9	106,0	4120M0012	4120M0012R20	--	--

## Cross kits with grease fitting on central body

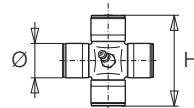

	Bondioli & Pavesi Italy bearings				Bondioli & Pavesi China bearings	
	Ø mm	H mm	Cross Kit Code	Multiple-item pack code	Cross Kit Code	Multiple-item pack code
<b>1</b>	22,0	54,0	--	--	41201A005A	41201A005AR50
<b>2</b>	23,8	61,3	41202A001A	41202A001AR30	41202A005A	41202A005AR30
<b>4</b>	27,0	74,6	41204A001A	41204A001AR25	41204A005A	41204A005AR25
<b>5</b>	30,2	79,4	41205A001A	41205A001AR40	41205A005A	41205A005AR40
<b>6</b>	30,2	91,4	41206A001A	41206A001AR30	41206A005A	41206A005AR30

# Telescoping members

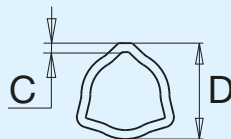
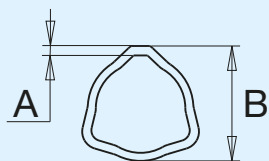

Outer tube

Inner tube

	A	B	Profile code	1 m Cut / Drilled tube code	C	D	Profile code	Cut / Drilled tube code
	mm	mm			mm	mm		
<b>1</b>	2,6	32,5	12503	225021000R	4,0	26,5	12502	225011000R
<b>2</b>	3,2	36,0	12505	225051000R	4,0	29,0	12504	225041000R
<b>4</b>	3,4	43,5	12508	225121000R	4,0	36,0	12507	225101000R
<b>5</b>	3,0	51,5	12510	225701000R	4,0	44,8	12537	225671000R
<b>6</b>	4,0	54,0	12512	225211000R	4,0	44,8	12537	225671000R
<b>G9</b>	4,0	63,0	12522	225721000R	4,0	54,0	12512	225711000R

Tubes for spare parts are supplied either in 1,5 meter sections, 1 meter sections, or 1-meter tubes drilled for roll pin.

Add "1500" or "1000" to the profile code to order 1,5 meter or 1 meter tubes respectively.

The 1 meter drilled tube codes are shown in the chart.

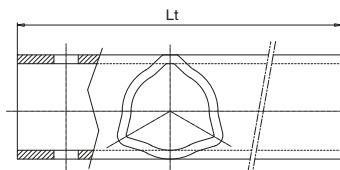

# Driveline length

Driveline length L is defined as the distance between the centers of the crosses, with the driveline fully collapsed.

Driveline length is represented in the code by the length L in centimeters.

Standard available lengths with codes are shown in the table below.

Max recommended lengths:

Lw : max working length;

Lt : max temporary length;

Ls : max length at stand still

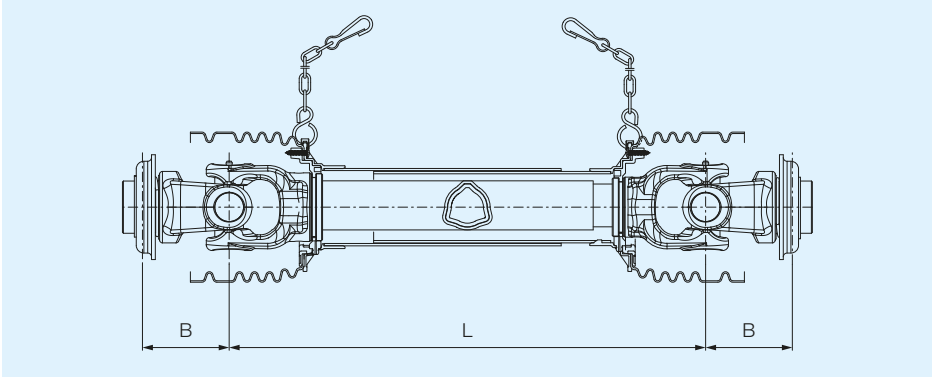

Code	041	046	051	056	061	066	071	076	081	086	091	101	111	121	
Length L (mm)	410	460	510	560	610	660	710	760	810	860	910	1010	1110	1210	
<b>1</b>	Lw	514	612	687	762	837	912	987	1062	1137	1212	1287	*1437	*1587	*1737
	Lt	564	662	746	829	912	996	1079	1162	1246	1329	1412	*1579	*1746	*1912
	Ls	593	688	775	863	950	1038	1125	1213	1300	1388	1475	1650	1825	2000
<b>2</b>	Lw	506	606	683	758	833	908	983	1058	1133	1208	1283	1433	*1583	*1733
	Lt	556	656	740	824	907	990	1074	1157	1240	1324	1407	1574	*1740	*1907
	Ls	585	682	769	857	944	1032	1119	1207	1294	1382	1469	1644	1819	1994
<b>4</b>	Lw	490	590	675	750	825	900	975	1050	1125	1200	1275	1425	1575	*1725
	Lt	540	640	730	813	896	980	1063	1146	1230	1313	1396	1563	1730	*1896
	Ls	565	665	757	845	932	1020	1107	1195	1282	1370	1457	1632	1807	1982
<b>5</b>	Lw	--	499	599	699	799	892	967	1042	1117	1192	1267	1417	1567	1717
	Lt	--	574	674	774	874	969	1052	1136	1219	1302	1386	1552	1719	1886
	Ls	--	647	745	833	920	1008	1095	1183	1270	1358	1445	1620	1795	1970
<b>6</b>	Lw	--	485	585	685	785	885	960	1035	1110	1185	1260	1410	1560	1710
	Lt	--	560	660	760	860	960	1043	1126	1210	1293	1376	1543	1710	1876
	Ls	--	633	733	822	910	997	1085	1172	1260	1347	1435	1610	1785	1960
<b>G9</b>	Lw	--	--	555	655	755	855	945	1020	1095	1170	1245	1395	1545	1695
	Lt	--	--	630	730	830	930	1023	1106	1190	1273	1356	1523	1690	1856
	Ls	--	--	695	795	887	975	1062	1150	1237	1325	1412	1587	1762	1937



Lw and Lt refer to drivelines rotating at a maximum speed of 1000 rpm, except for items marked \*, which refer to a maximum speed of 540 rpm. For shaft lengths longer than those shown, or for speed higher than 1000 rpm, please contact Bondioli & Pavesi Engineering Department

# Safety labels and operator's manuals

Bondioli & Pavesi driveshafts are provided with safety labels and operator's manuals as prescribed by international safety standards and regulations.

The country of destination of the driveline, and consequently the labels and operator's manual are selected by positions ten and eleven in the driveline code.

Drivelines bearing CE and UKCA marks.  
code **CE**

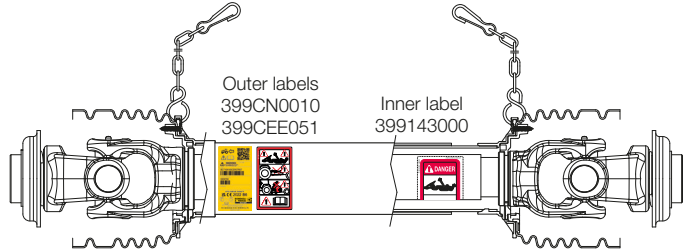

Drivelines bearing CE, UKCA marks and both CE and US labels.  
code **CU**

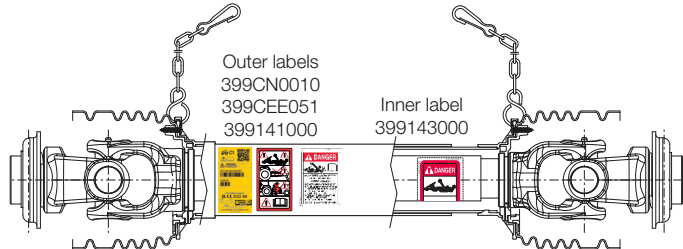

Drivelines for North America (USA, Canada, Mexico) without restraint chains.  
code **US**

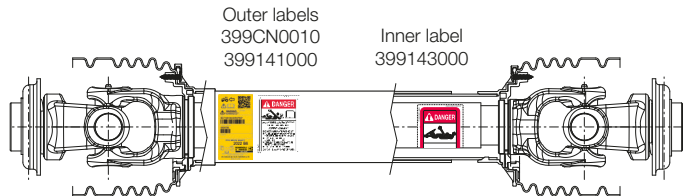

# Safety labels and operator's manuals

Drivelines for North America (USA, Canada, Mexico) with restraint chains.  
code **UC** (**U2** for G9 size)



Operator's manual  
399UNI001

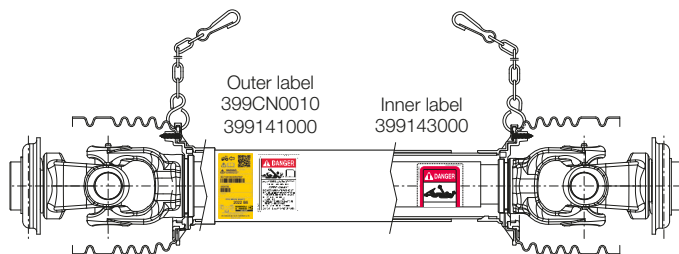

Drivelines for Japan.  
code **JP**



Operator's manual  
399UNI001

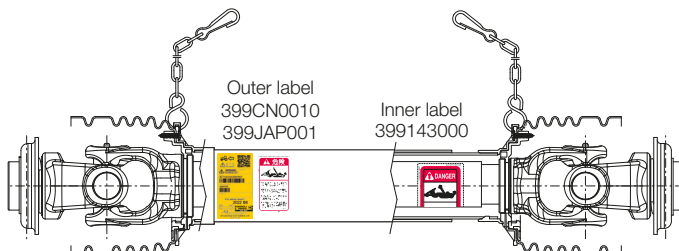

Drivelines for other countries and CEE-EFTA countries not bearing CE mark.  
code **FX**



Operator's manual  
399UNI001

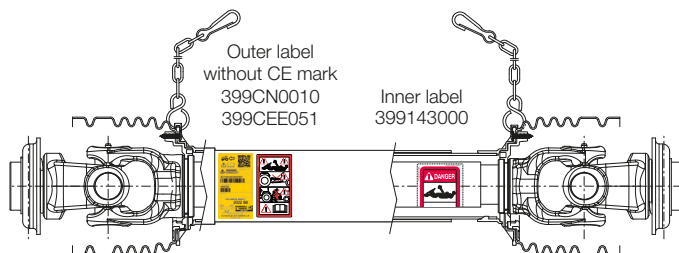

# Safety labels and operator's manuals

## Outer labels

The outer label displays basic safety information for using the driveline, presented according to the rules existing in the country of destination.

In Europe, the Machinery Directive requires that information shown on the outer label be understood in the language of the country of destination, which in practice means all EEC languages. For this reason, label no. 399CEE051 provides information by means of illustrations. This label is used for all driveshafts with CE and UKCA marks, as well as other countries.



Outer label  
399CEE051

In North America (United States, Canada, Mexico) standards ASABE AD11684, ASABE S604, and ANSI Z535 detail the requirements for labels. Drivelines for sale into North America are provided with the outer label no. 399141000.

Drivelines bound for Japan are provided with the outer label no. 399JAP001.



Outer label  
399141000



Outer label  
399JAP001

The outer label no. 399CN0010 includes the following information:

- Symbol indicating end of driveline to be mounted toward tractor;
- A QR code, that allows access to the operator's manuals on internet by a mobile device, containing explanations on the labels, information on safe and correct driveline use, and instructions for proper maintenance;
- Production lot (W.Order);
- Driveshaft code;
- Customer reference;
- Type of implement;
- CE and UKCA marks when needed, year of production and driveshaft size;
- The name and address of the manufacturer.



Outer label  
399CN0010

# Safety labels and operator's manuals

## Inner label

This safety label draws the operator's attention to the fact that the protective guard is missing and therefore this hazard is described graphically with a person entangled with a rotating shaft.

In addition, the signal word "DANGER" is used, which is understood throughout the world.

Inner label no. 399143000 is applied on the outer profile tube, under the protective guard, and provided on drivelines for all countries.



Inner label  
399143000

## Operator's manual

The operator's manual 399UNI001 is provided with all drivelines. It contains explanations for the labels, information for safe and correct driveline use, and proper maintenance instructions.

Machinery Directive 2006/42/CE specifies that drivelines between self-powered vehicles (or tractors) and implements, marketed in EU and EFTA countries, shall be CE marked.

The Product Safety and Metrology etc. (Amendment etc.) (EU Exit) Regulations 2019 similarly requires that primary drive-shafts marketed in Great Britain shall be UKCA marked.

The manual 399UNI001 includes a Declaration of Compliance with Machinery Directive 2006/42/CE, and UK Declaration of Conformity.



Operator's manual  
399UNI001



# Safety shields

## Complete shield kit

Complete shield kits for spare parts are sized to fit the drivelines on which they will be used. The code for the shield kit length is the same code used for the driveline length.

 Shield tubes can be cut to fit a specific driveline length, but the shield tubes should maintain sufficient overlap for all operating and transport conditions.

Safety labels and operator's manuals are included according to the standards and regulations of the country of destination. Shield kits are supplied with chains (optional in North America).

Drivelines and shields are tested to comply with EN ISO 5674 / ASABE AD5674, EN 12965 standards and are CE and UKCA certified.

Complete shields are supplied as spare parts and therefore, in compliance with Machinery Directive, do not require CE marking. However, shield kits may be CE marked upon request.

 Regulation EN ISO 4254-1 and ASABE AD5673-1 prescribe a 50 mm overlap of the driveline shield with the implement input connection shields.

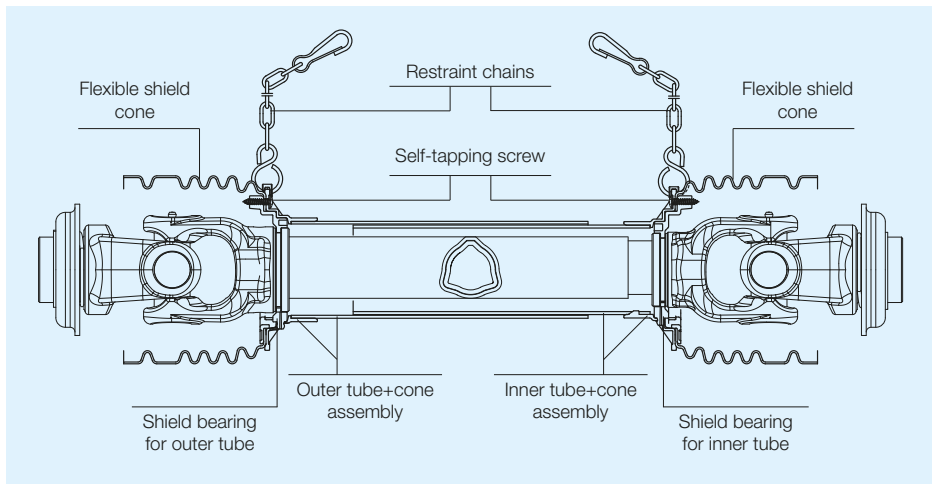

# Safety shields

## Shield cones configurations

Size: 1

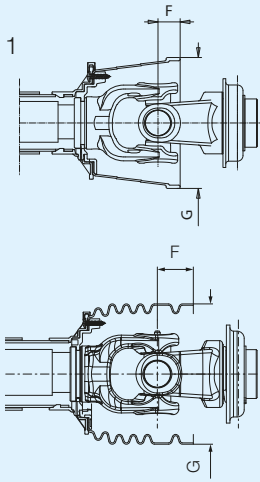

Standard shield cones for yokes and FFL friction clutches.

	F	G
	mm	mm
1	23	132
2	20	132
4	24	140
5	33	165
6	26	165
G9	30	160

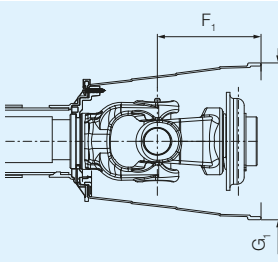

Extended cones.

To select this cone, available for implement side, add the letter "N" at the end of drive-line's code

	F <sub>1</sub>	G <sub>1</sub>
	mm	mm
1	92	141
2	89	141
4	96	143
5	116	176
6	109	176
G9	--	--

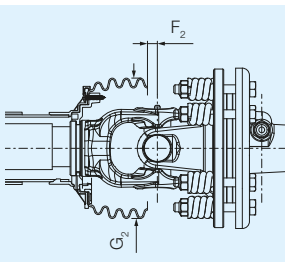

Shield cones for FFF friction clutches.

Driveline with FFF clutches are not CE marked since the shield cone does not entirely cover the inboard yoke, as specified by machinery Directive 98/37/CEE.

	F <sub>2</sub>	G <sub>2</sub>
	mm	mm
4	19	125
5	18	145
6	25	145

# Safety shields

Code for complete shield kit as spare part for sizes 1 - 2 - 4 - 5 - 6

Size G9 see next page

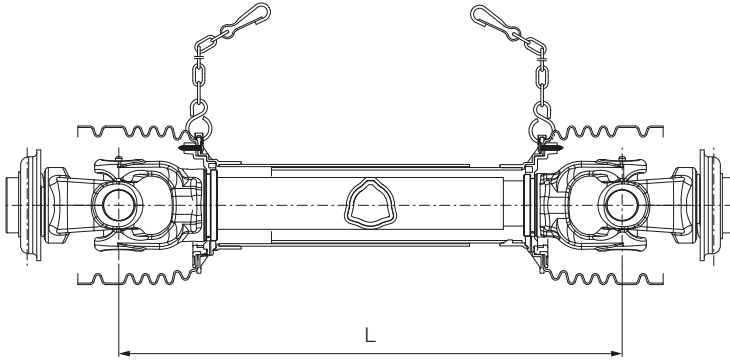

5F : Standard driveline



Size  
 1 - 2 - 4 - 5 - 6



Length  
 041 - 046 - 051 - 056 - 061 - 066 - 071 - 076 - 081 - 086 - 091 - 101 - 111 - 121  
 See page 11 "Driveline length".



Shield cone	Driver end	Driven end
Standard shield cone:	F	F
Extended shield cone:	--	N
Shield cone for FFF friction clutches	S	S

(Not available with CE/UKCA mark)



**Safety labels and instruction manuals and restraint chains**  
 CE - Drivelines with CE and UKCA mark.  
 CU - Drivelines with CE, UKCA and both CE, UKCA and North America labels.  
 US - Drivelines for North America (USA, Canada, Mexico), without restraint chains.  
 UC - Drivelines for North America (USA, Canada, Mexico), with restraint chains.  
 JP - Drivelines for Japan.  
 FX - Drivelines for other countries or CEE-EFTA countries not bearing CE mark.



All rotating parts must be guarded. The shields on the tractor and on the implement work with the integral driveline guard to form an interactive guarding system.

# Safety shields

Code for complete shield kit as spare part for size G9

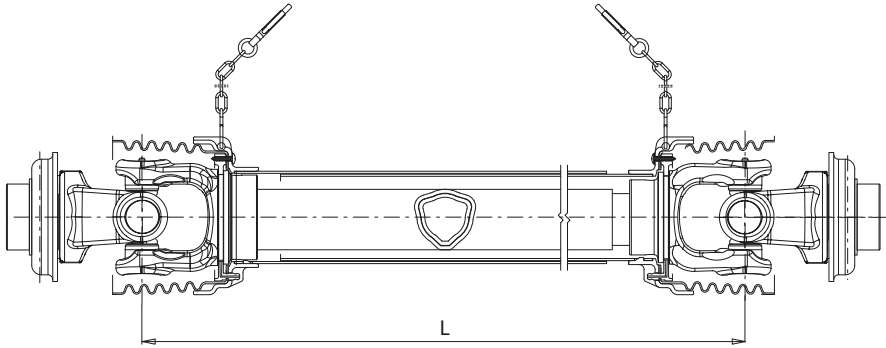

1 2  
5 C

5F : Standard driveline

3 4  
G 9

Size  
G9

5 6 7

Length

041 - 046 - 051 - 056 - 061 - 066 - 071 - 076 - 081 - 086 - 091 - 101 - 111 - 121  
See page 11 "Driveline length".

8 9

Safety labels and instruction manuals and restraint chains

- CE - Drivelines with CE and UKCA mark.
- CU - Drivelines with CE, UKCA and both CE, UKCA and North America labels.
- US - Drivelines for North America (USA, Canada, Mexico), without restraint chains.
- U2 - Drivelines for North America (USA, Canada, Mexico), with restraint chains.
- JP - Drivelines for Japan.
- FX - Drivelines for other countries or CEE-EFTA countries not bearing CE mark.

10 11  
S S

Shield cone  
Standard shield cone:

Driver end  
S

Driven end  
S



All rotating parts must be guarded. The shields on the tractor and on the implement work with the integral driveline guard to form an interactive guarding system.

# Safety shields

## Spare Parts

### Shield bearing for outer tube

	E	D	Spare part code
	mm	mm	
1	40,4	103,0	25501CA01R02
2	47,4	103,0	25502CA01R02
4	53,4	109,3	25504CA01R02
5	62,4	124,0	25505CA01R02
6	68,4	124,0	25506CA01R02

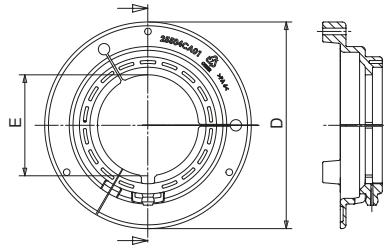

### Shield bearing for inner tube

	E	D	Spare part code
	mm	mm	
1	34,4	103,0	25501CA02R02
2	40,4	103,0	25502CA02R02
4	46,4	109,3	25504CA02R02
5	53,4	124,0	25505CA02R02
6	59,4	124,0	25506CA02R02

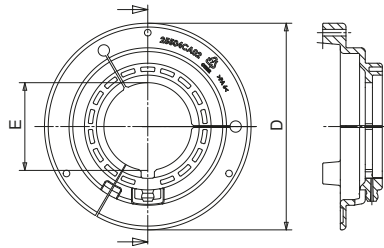

### Shield bearing for outer tube

	Spare part code
G9	2550G0001R02

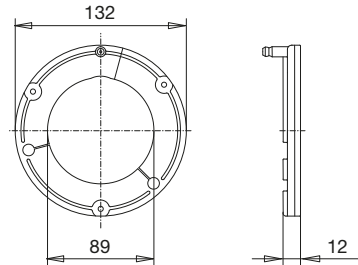

### Shield bearing for inner tube

	Spare part code
G9	2550G0002R02

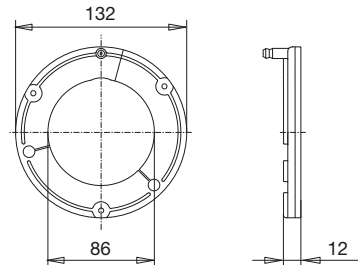

The spare part number of the multi-packs ends with a letter "R" and two digits that show the number of units per package.

## RT Ball collar yokes

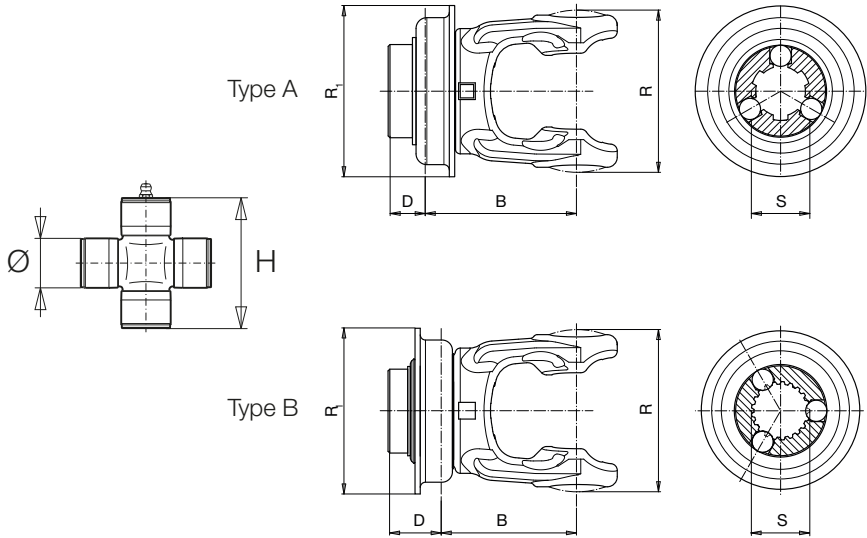

	Ø	H	S	D	B	R <sub>1</sub>	R	Type	End Code	Spare part Code	Ball collar Code
	mm	mm		mm	mm	mm	mm				
<b>1</b>	22,0	54,0	1 3/8" Z6	18	75	95	68	A	<b>R07</b>	5720B0380A	435000316R
			1 3/8" Z21	28	65	95	68	B	<b>R08</b>	5720B3780A	435000300R
<b>2</b>	23,8	61,3	1 3/8" Z6	21	78	95	76	A	<b>R07</b>	5720C0380A	435000316R
			1 3/8" Z21	31	68	95	76	B	<b>R08</b>	5720C3780A	435000300R
			D8x32x38	21	78	110	76	A	<b>R93</b>	5720C2152A	435002121R
<b>4</b>	27,0	74,6	1 3/8" Z6	21	85	95	89	A	<b>R07</b>	5720E0379A	435000316R
			1 3/8" Z21	31	75	95	89	B	<b>R08</b>	5720E3779A	435000300R
			D8x32x38	21	85	110	89	A	<b>R93</b>	5720E2152A	435002121R
<b>5</b>	30,2	79,4	1 3/8" Z6	21	91	110	98	A	<b>R07</b>	5720G0381A	435000315R
			1 3/8" Z21	31	81	110	98	B	<b>R08</b>	5720G3781A	435000302R
			D8x32x38	21	91	110	98	A	<b>R93</b>	5720G2152A	435002121R
<b>6</b>	30,2	91,4	1 3/8" Z6	21	98	110	108	A	<b>R07</b>	5720H0379A	435000315R
			1 3/8" Z21	31	88	110	108	B	<b>R08</b>	5720H3779A	435000302R
			D8x32x38	21	98	110	108	A	<b>R93</b>	5720H2152A	435002121R
			1 3/4" Z6	31	100	135	108	A	<b>R09</b>	5720H0479A	435000415R
			1 3/4" Z20	31	100	135	108	A	<b>R10</b>	5720H3879A	435000415R
<b>G9</b>	34,9	106,0	D8x42x48	24	95	135	108	A	<b>R92</b>	5720H9951A	435000003R
			1 3/8" Z6	35	109	135	124	A	<b>R07</b>	5720M0354A	435000322R
			1 3/8" Z21	35	109	135	124	A	<b>R08</b>	5720M3754A	435000322R
			D8x32x38	35	109	135	124	A	<b>R93</b>	5720M2154A	435002116R
			1 3/4" Z6	35	109	135	124	A	<b>R09</b>	5720M0454A	435000415R
D8x42x48	1 3/4" Z20	35	109	135	124	A	<b>R10</b>	5720M3854A	435000415R		
	D8x42x48	24	107	135	124	A	<b>R92</b>	5720M9951A	435000003R		

# Yokes

## Spring pin hole yokes

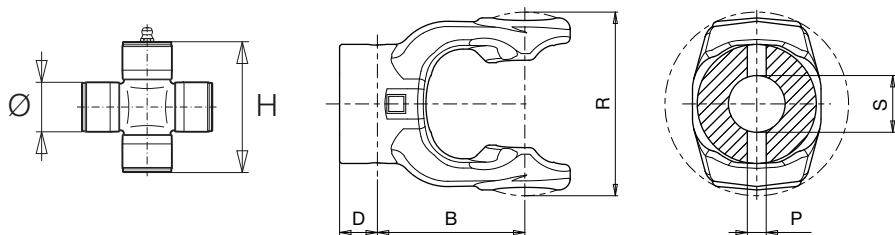

	Ø	H	SH <sup>8</sup>	PH <sup>12</sup>	D	B	R	End Code	Spare part Code
	mm	mm	mm	mm	mm	mm	mm		
4	27,0	74,6	30	10	20	70	94	072	2110E4853A
5	30,2	79,4	30	10	20	78	96	072	211054852A
			35	13	20	78	96	073	211054957A
6	30,2	91,4	35	13	20	85	108	070	211064951A

## Round bore cutter yokes

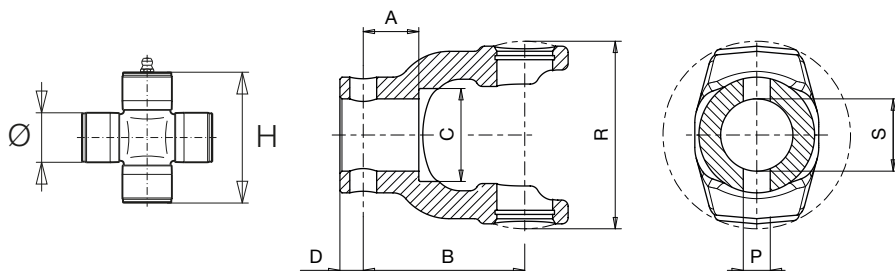

	Ø	H	SH <sup>8</sup>	PH <sup>12</sup>	D	B	R	A	C	End Code	Spare part Code
	mm	mm	mm	mm	mm	mm	mm	mm	mm		
4	27,0	74,6	35	13	11	70	94	26,9	45	073	211044964A
5	30,2	79,4	35	13	16,2	81,3	96	27,8	43	A73	211054958A

## Round bore cutter yokes and grease fitting

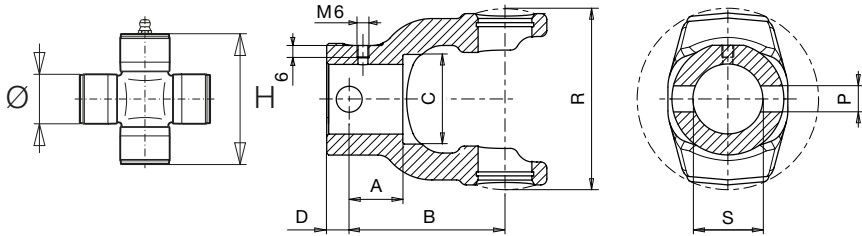

	Ø	H	SH <sup>8</sup>	PH12	D	B	R	A	C	End Code	Spare part Code
	mm	mm	mm	mm	mm	mm	mm	mm	mm		
4	27,0	74,6	35	13	11,3	78,2	94	26,9	45	A74	211044965A

## Taper-pin yokes for shaft with counter-clockwise rotation

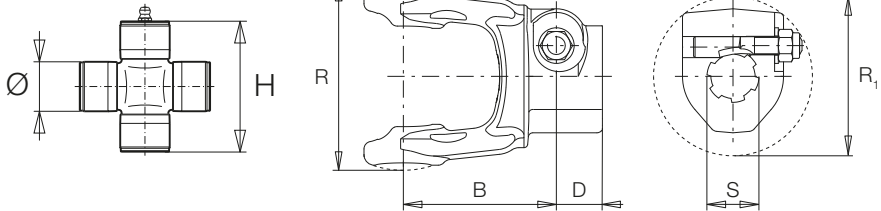

	Ø	H	S	D	B	R <sub>1</sub>	R	End Code	Spare part Code	
	mm	mm		mm	mm	mm	mm			
G9	34,9	106,0	1 3/8" Z6	31	103	107	124	014	5090M0360A	408000075R
			1 3/4" Z20	31	103	124	124	017	5090M3860A	408000076R

Recommended tightening torque:

- 150 Nm for profiles 1 3/8" Z6
- 220 Nm for profiles 1 3/4" Z20



# Yokes

## Outer tube yokes

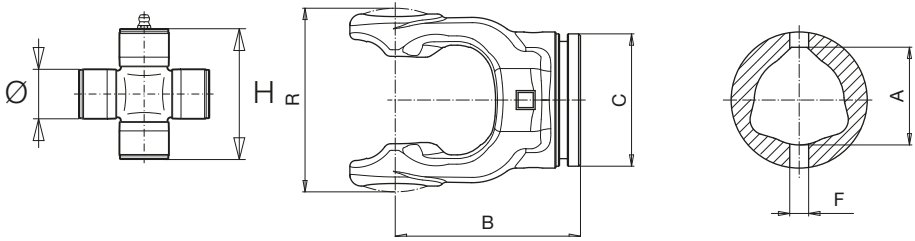

	Ø	H	R	B	C	F	A	Spare part Code	Spring pin Code
	mm	mm	mm	mm	mm	mm	mm		
<b>1</b>	22,0	54,0	69	78	47	8	32,5	204016888A	341036000R10
<b>2</b>	23,8	61,3	76	82	54	8	36,0	204026888A	341048000R10
<b>4</b>	27,0	74,6	91	90	61	8	43,5	204046890A	341038000R10
<b>5</b>	30,2	79,4	98	98	70	10	51,6	204056888A	341053000R10
<b>6</b>	30,2	91,4	108	105	76	10	54,0	204066888A	341042000R10
<b>G9</b>	34,9	106,4	132	120	88	12	63,0	204086803AR	341045000R10

## Inner tube yokes

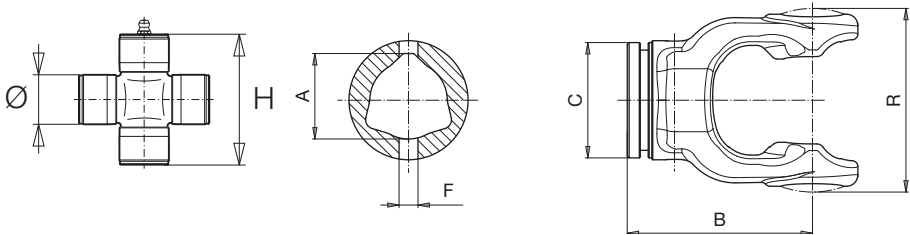

	Ø	H	A	F	C	B	R	Spare part Code	Spring pin Code
	mm	mm	mm	mm	mm	mm	mm		
<b>1</b>	22,0	54,0	26,5	8	41	78	69	204016889A	341037000R10
<b>2</b>	23,8	61,3	29,0	8	47	82	76	204026889A	341036000R10
<b>4</b>	27,0	74,6	36,0	8	54	90	91	204046891A	341048000R10
<b>5</b>	30,2	79,4	45,0	10	61	98	98	204056889A	341002000R10
<b>6</b>	30,2	91,4	45,0	10	67	105	108	204066889A	341043000R10
<b>G9</b>	34,9	106,4	54,0	12	78	120	132	204086804AR	341055000R10

The spare part number of the multi-packs ends with a letter "R" and two digits that show the number of units per package.

# Overrunning clutches

## RA1

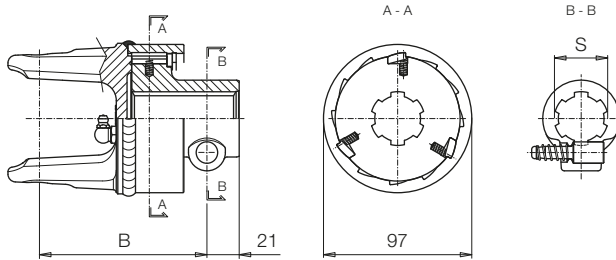

Size	B (mm)				
	S = 1 3/8" Z6	1 3/8" Z21	1 3/4" Z6	1 3/4" Z20	D8x32x38
2	100	100	--	--	100
4	109	109	--	--	109
5	112	112	--	--	112
6	119	119	--	--	119

### RA1 Driveline codes

Max torque					
2400 Nm	S = 1 3/8" Z6	1 3/8" Z21	1 3/4" Z6	1 3/4" Z20	D8x32x38
	<b>096</b>	<b>631</b>	--	--	<b>A41</b>

### RA1 Spare part codes

Size	S = 1 3/8" Z6				
	1 3/8" Z21	1 3/4" Z6	1 3/4" Z20	D8x32x38	
2	BC601102701R	BC601102702R	--	--	BC601102705R
4	BC601104701R	BC601104702R	--	--	BC601104706R
5	BC601105704R	BC601105702R	--	--	BC601105706R
6	BC601106704R	BC601106702R	--	--	BC601106709R



All rotating parts must be guarded. The shields on the tractor and on the implement work with the integral driveline guard to form an interactive guarding system.

# Overrunning clutches

RA1

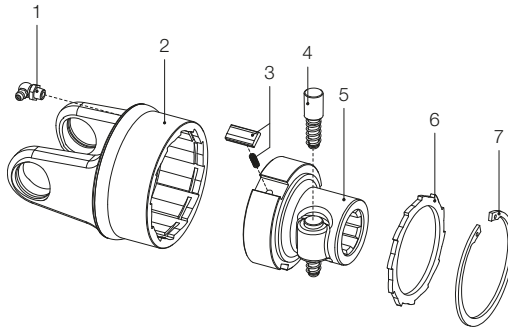

Ref.	Size	Spare part code	Description	Technical notes
1		348014000R20	Grease fitting	
2	2	418021201R	Outer housing + yoke	
4		418041203R		
5		418051201R		
6		418061201R		
3		4210C0001R03	Pawl + springs kit	
4		403000022R10	Push pin	
5		5130C0302R	Hub with push pin	1 3/8" Z6
		5130C3702R		1 3/8" Z21
		5130C2102R		D8x32x38
6		246000132R02	Locking plate	
7		338005000R20	Snap ring	82 x 2,5 DIN 472/1

The spare part number of the multi-packs ends with a letter "R" and two digits that show the number of units per package.

# Overrunning clutches

## RA2

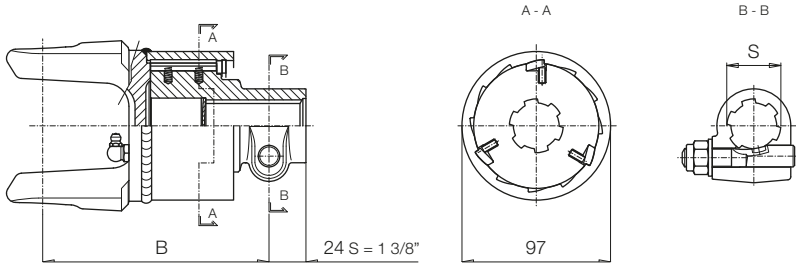

Size	B (mm)			
	S = 1 3/8" Z6	1 3/8" Z21	1 3/4" Z6	1 3/4" Z20
6	147	147	--	--

### RA2 Driveline codes

Max torque				
3800 Nm	S = 1 3/8" Z6	1 3/8" Z21	1 3/4" Z6	1 3/4" Z20
	A50	A51	--	--

### RA2 Spare part codes

Size	Spare part codes			
	S = 1 3/8" Z6	1 3/8" Z21	1 3/4" Z6	1 3/4" Z20
6	BC601206601R	BC601206602R	--	--



All rotating parts must be guarded. The shields on the tractor and on the implement work with the integral driveline guard to form an interactive guarding system.

# Overrunning clutches

RA2

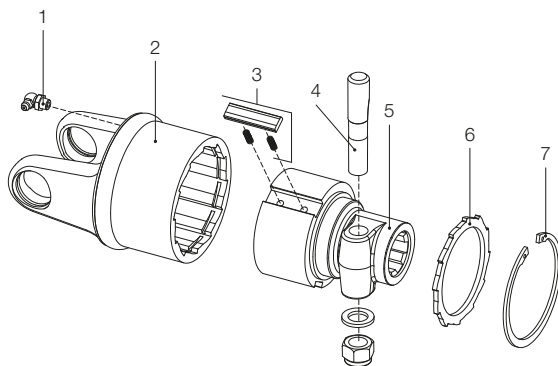

Ref.	Size	Spare part code	Description	Technical notes
1		348014000R20	Grease fitting	
2	<b>6</b>	418062203R	Outer housing + yoke	
3		4210E0001R03	Pawl + springs kit	
4		408000047R02	Taper pin	1 3/8" Z6 - Z21
5		5150E0301R 5150E3701R	Hub with taper pin	1 3/8" Z6 1 3/8" Z21
6		246000132R02	Locking plate	
7		338005000R20	Snap ring	82 x 2,5 DIN 472/1

The spare part number of the multi-packs ends with a letter "R" and two digits that show the number of units per package.

# Shear bolt torque limiter

LB

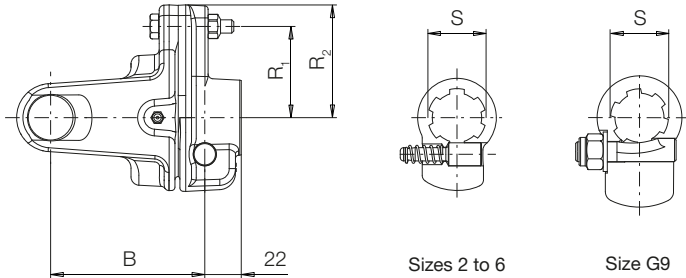

## LB Driveline codes

Size	Setting						B mm	R <sub>1</sub> mm	R <sub>2</sub> mm
	Nm	S = 1 3/8" Z6	1 3/8" Z21	1 3/4" Z6	1 3/4" Z20	D8x32x38			
2	950	<b>098</b>	<b>161</b>	--	--	--	87	55	68
4	1400	<b>1R0</b>	<b>1S0</b>	--	--	--	93	45	68
	1700	<b>098</b>	<b>161</b>	--	--	--	93	55	68
	2000	<b>1R2</b>	<b>1S2</b>	--	--	--	93	43	68
5	2100	<b>1R0</b>	<b>1S0</b>	--	--	--	106	67	80
	2400	<b>1R1</b>	<b>1S1</b>	--	--	<b>1Q6</b>	106	50	80
6	2400	<b>1R0</b>	<b>1S0</b>	--	--	<b>1Q5</b>	112	50	80
	2700	<b>098</b>	<b>161</b>	--	--	<b>1Q4</b>	112	55	80
G9	3000	<b>1R0</b>	--	--	--	--	121	62	80

## LB Spare part codes

Size	Setting						Shear bolt dimensions
	Nm	S = 1 3/8" Z6	1 3/8" Z21	1 3/4" Z6	1 3/4" Z20	D8x32x38	
2	950	BC6060C0302R	BC6060C3702R	--	--	--	M6 x 40 cl.8.8
4	1400	BC6060E0303R	BC6060E3704R	--	--	--	M8 x 45 cl.8.8
	1700	BC6060E0302R	BC6060E3702R	--	--	--	M8 x 45 cl.8.8
	2000	BC6060E0309R	BC6060E3711R	--	--	--	M10 x 50 cl.8.8
5	2100	BC6060G0322R	BC6060G3712R	--	--	--	M8 x 50 cl.8.8
	2400	BC6060G0314R	BC6060G3713R	--	--	BC6060G2105R	M10 x 50 cl.8.8
6	2400	BC6060H0312R	BC6060H3710R	--	--	BC6060H2101R	M10 x 50 cl.8.8
	2700	BC6060H0315R	BC6060H3711R	--	--	BC6060H2102R	M10 x 50 cl.8.8
G9	3000	BC6060M0360R	--	--	--	--	M10 x 50 cl.8.8



To avoid excessive wear to the implement, driveline, or tractor, Bondioli & Pavesi recommends that the defined setting not to be altered.



All rotating parts must be guarded. The shields on the tractor and on the implement work with the integral driveline guard to form an interactive guarding system.

# Shear bolt torque limiters

LB

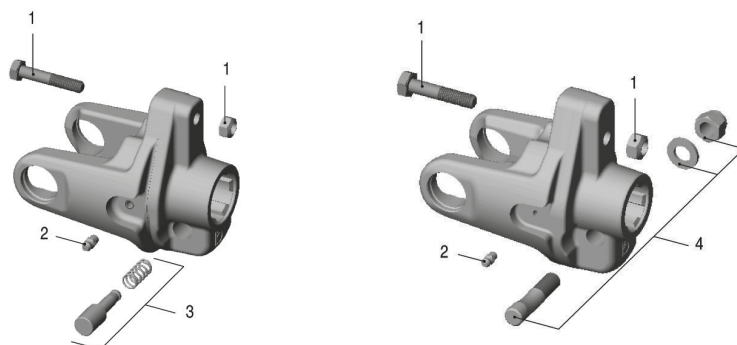

Ref.	Size	Spare part code	Description	Technical notes
1		432000002R05 432000047R05 432000003R05 432000053R05	Shear bolt	M6 x 40 mm cl 8.8 M8 x 45 mm cl 8.8 M8 x 50 mm cl 8.8 M10 x 50 mm cl 8.8
2		348017000R20	Grease fitting	
3		403000022R10	Push pin kit	
4		408000048R02	Taper pin	1 3/8" Z6

The spare part number of the multi-packs ends with a letter "R" and two digits that show the number of units per package.

# Friction torque limiters FFL

## FFL22A

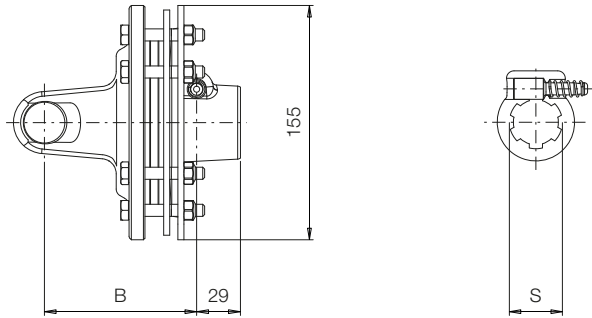

Size	Setting	B (mm)			
	Nm	S = 1 3/8" Z6	1 3/8" Z21	1 3/4" Z6	1 3/4" Z20
4	450	101	101	--	--
	600	101	101	--	--
	800	101	101	--	--

### FFL22A Driveline codes

Setting	Nm	S = 1 3/8" Z6	1 3/8" Z21	1 3/4" Z6	1 3/4" Z20
600	2L2	2L7	--	--	
800	2L3	2L8	--	--	

### FFL22A Spare part codes

Size	Setting	S = 1 3/8" Z6	1 3/8" Z21	1 3/4" Z6	1 3/4" Z20
	Nm				
4	450	BC669E26103R	BC669E26137R	--	--
	600	BC669E32103R	BC669E32137R	--	--
	800	BC669E39103R	BC669E39137R	--	--



To avoid excessive wear to the implement, driveline, or tractor, Bondioli & Pavesi recommends that the defined setting not to be altered.



All rotating parts must be guarded. The shields on the tractor and on the implement work with the integral driveline guard to form an interactive guarding system.



# Friction torque limiters FFL

FFL22A

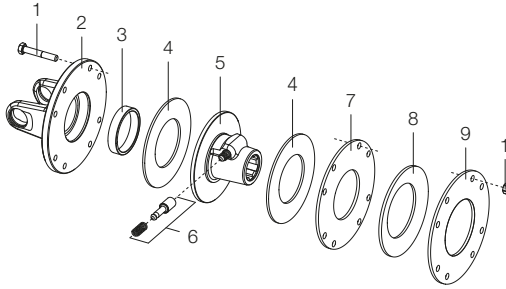

Ref.	Size	Spare part code	Description	Technical notes
1		432000003R08	Bolt	M8 x 50 mm cl 8.8
2	4	2530E1A05R	Flange yoke	
3		258005320R02	Bushing	
4		247006151R08	Friction lining	D = 124 ; d = 67 mm
5		513850306R 513853706R	Hub with push pin	1 3/8" Z6 1 3/8" Z21
6		403000022R10	Push pin kit	1 3/8" Z6 - Z21
7		2481A0007R02	Inner disc	Sp = 4 mm
8		367001151R	Belleville spring	
9		2481A0008R02	Pressure disc	Sp = 4 mm

The spare part number of the multi-packs ends with a letter "R" and two digits that show the number of units per package.



Friction clutches may become hot.

Do not touch!

Keep the area around the friction clutch clear of any material that could catch fire, and avoid prolonged slipping that will generate excess heat and wear

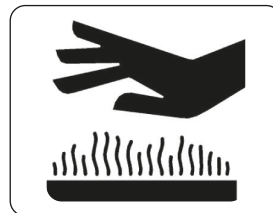

# Friction torque limiters FFL

## FFL32A

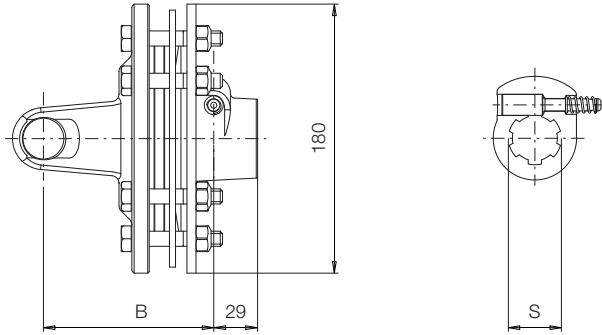

Size	Setting	B (mm)				
	Nm	S = 1 3/8" Z6	1 3/8" Z21	1 3/4" Z6	1 3/4" Z20	D8x32x38
4	900	113	113	--	--	113
	1050	113	113	--	--	113
5	900	117	117	--	--	--
	1100	117	117	--	--	--
6	900	125	125	--	--	--
	1100	125	125	--	--	--

### FFL32A Driveline codes

Setting	B (mm)					
	Nm	S = 1 3/8" Z6	1 3/8" Z21	1 3/4" Z6	1 3/4" Z20	D8x32x38
900		<b>2M0</b>	<b>2M5</b>	--	--	<b>2Y1</b>
1050		<b>2M1</b>	<b>2M6</b>	--	--	<b>2Y2</b>
1100		<b>2M2</b>	<b>2M7</b>	--	--	--

### FFL32A Spare part codes

Size	Setting	B (mm)				
	Nm	S = 1 3/8" Z6	1 3/8" Z21	1 3/4" Z6	1 3/4" Z20	D8x32x38
4	900	BC669E41203R	BC669E41237R	--	--	BC669E41221R
	1050	BC669E45203R	BC669E45237R	--	--	BC669E45221R
5	900	BC669G41203R	BC669G41237R	--	--	--
	1100	BC669G46203R	BC669G46237R	--	--	--
6	900	BC669H41203R	BC669H41237R	--	--	--
	1100	BC669H46203R	BC669H46237R	--	--	--



To avoid excessive wear to the implement, driveline, or tractor, Bondioli & Pavesi recommends that the defined setting not be altered.



All rotating parts must be guarded. The shields on the tractor and on the implement work with the integral driveline guard to form an interactive guarding system.

# Friction torque limiters FFL

FFL32A

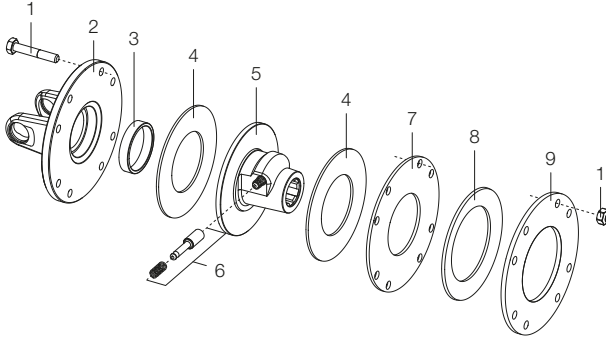

Ref.	Size	Spare part code	Description	Technical notes
1		432000008R08	Bolt	M10 x 60 mm cl 8.8
2	4	2530E1C05R	Flange yoke	
	5	2530G1C05R		
	6	2530H1C05R		
3		258005320R02	Bushing	
4		247006251R08	Friction lining	D = 141 ; d = 77 mm
5		513860302R 513863701R 513862101R	Hub with push pin	1 3/8" Z6 1 3/8" Z21 D8x32x38
6		403000002R10	Push pin kit	1 3/8" Z6 - Z21 D8x32x38
7		2481C0007R02	Inner disc	Sp = 4 mm
8		367002200R	Belleville spring	
9		248200001R02	Pressure disc	Sp = 6 mm

The spare part number of the multi-packs ends with a letter "R" and two digits that show the number of units per package.



Friction clutches may become hot.

Do not touch!

Keep the area around the friction clutch clear of any material that could catch fire, and avoid prolonged slipping that will generate excess heat and wear

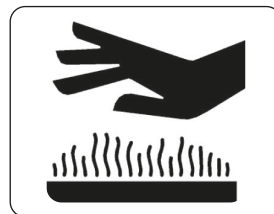

# Friction torque limiters FFL

## FFL42A

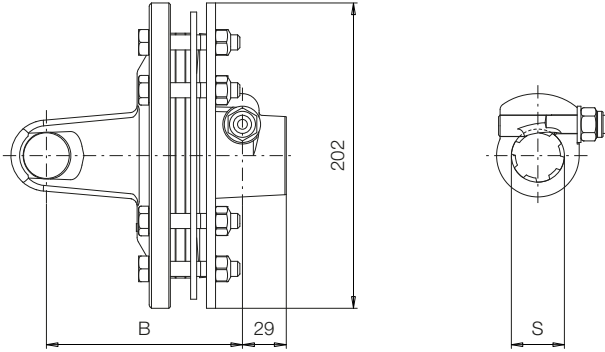

Size	Setting	B (mm)			
	Nm	S = 1 3/8" Z6	1 3/8" Z21	1 3/4" Z6	1 3/4" Z20
6	1200	130	--	--	130
	1350	--	--	--	130
	1450	130	130	130	130

### FFL42A Driveline codes

Setting	B (mm)				
	Nm	S = 1 3/8" Z6	1 3/8" Z21	1 3/4" Z6	1 3/4" Z20
1200	<b>3A0</b>	--	--	--	<b>3B5</b>
1350	--	--	--	--	<b>3B6</b>
1450	<b>3A2</b>	<b>3A8</b>	<b>3B2</b>	<b>3B7</b>	

### FFL42A Spare part codes

Size	Setting	B (mm)			
	Nm	S = 1 3/8" Z6	1 3/8" Z21	1 3/4" Z6	1 3/4" Z20
6	1200	BC669H48403R	--	--	BC669H48438R
	1350	--	--	--	BC669H51438R
	1450	BC669H53403R	BC669H53437R	BC669H53404R	BC669H53438R

 To avoid excessive wear to the implement, driveline, or tractor, Bondioli & Pavesi recommends that the defined setting not be altered.

 All rotating parts must be guarded. The shields on the tractor and on the implement work with the integral driveline guard to form an interactive guarding system.

# Friction torque limiters FFL

FFL42A

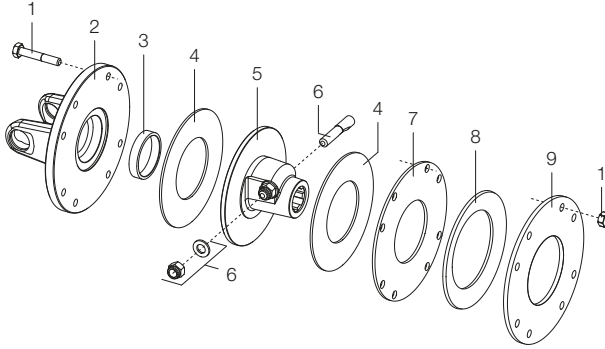

Ref.	Size	Spare part code	Description	Technical notes
1		432000008R08	Bolt	M10 x 60 mm cl 8.8
2	6	2530H1E05R	Flange yoke	
3		258005320R02	Bushing	
4		247006351R08	Friction lining	D = 162 ; d = 85 mm
5		515870304R 515873704R 515870404R 515873804R	Hub with taper pin	1 3/8" Z6 1 3/8" Z21 1 3/4" Z6 1 3/4" Z20
6		408000047R02 408000046R02	Taper pin kit	1 3/8" Z6 - Z21 1 3/4" Z6 - Z20
7		2481E0007R02	Inner disc	Sp = 4 mm
8		367002210R	Belleville spring	
9		248210002R02	Pressure disc	Sp = 6 mm

The spare part number of the multi-packs ends with a letter "R" and two digits that show the number of units per package.



Friction clutches may become hot.

Do not touch!

Keep the area around the friction clutch clear of any material that could catch fire, and avoid prolonged slipping that will generate excess heat and wear

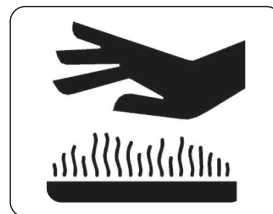

# Friction torque limiters FFL

## FFL34A

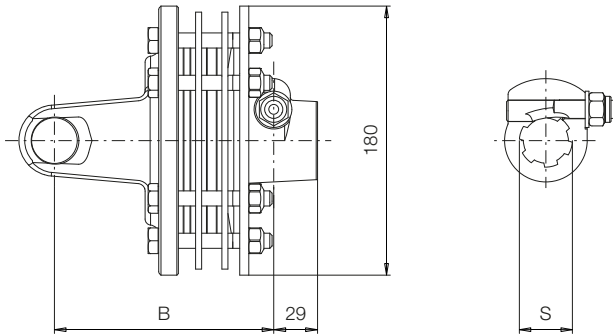

Size	Setting	B (mm)			
	Nm	S = 1 3/8" Z6	1 3/8" Z21	1 3/4" Z6	1 3/4" Z20
6	1450	145	145	145	145

### FFL34A Driveline codes

Setting	B (mm)				
	Nm	S = 1 3/8" Z6	1 3/8" Z21	1 3/4" Z6	1 3/4" Z20
1450	<b>2N2</b>	<b>2N9</b>	<b>2P6</b>	<b>2Q3</b>	

### FFL34A Spare part codes

Size	Setting	B (mm)			
	Nm	S = 1 3/8" Z6	1 3/8" Z21	1 3/4" Z6	1 3/4" Z20
6	1450	BC669H53303R	BC669H53337R	BC669H53304R	BC669H53338R



To avoid excessive wear to the implement, driveline, or tractor, Bondioli & Pavesi recommends that the defined setting not be altered.



All rotating parts must be guarded. The shields on the tractor and on the implement work with the integral driveline guard to form an interactive guarding system.

# Friction torque limiters FFL

FFL34A

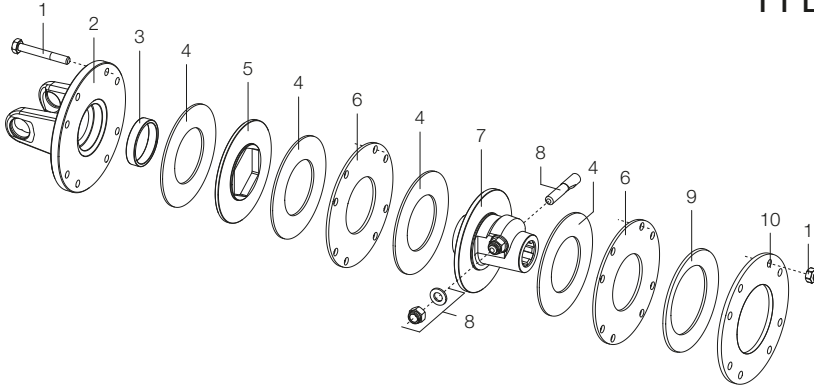

Ref.	Size	Spare part code	Description	Technical notes
1		432000134R08	Bolt	M10 x 75 mm cl 10.9
2	6	2530H1C05R	Flange yoke	
3		258005320R02	Bushing	
4		247006251R08	Friction lining	D = 141 ; d = 77 mm
5		248727701R	Driving disc	
6		2481C0007R02	Inner disc	Sp = 4 mm
7		515890304R 515893704R 515890404R 515893804R	Hub with taper pin	1 3/8" Z6 1 3/8" Z21 1 3/4" Z6 1 3/4" Z20
8		408000047R02 408000049R02	Taper pin kit	1 3/8" Z6 - Z21 1 3/4" Z6 - Z20
9		367002200R	Belleville spring	
10		248200001R02	Pressure disc	Sp = 6 mm

The spare part number of the multi-packs ends with a letter "R" and two digits that show the number of units per package.



Friction clutches may become hot.

Do not touch!

Keep the area around the friction clutch clear of any material that could catch fire, and avoid prolonged slipping that will generate excess heat and wear

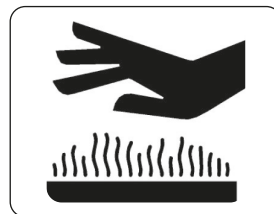

# Friction torque limiters FFF

## FFF22A

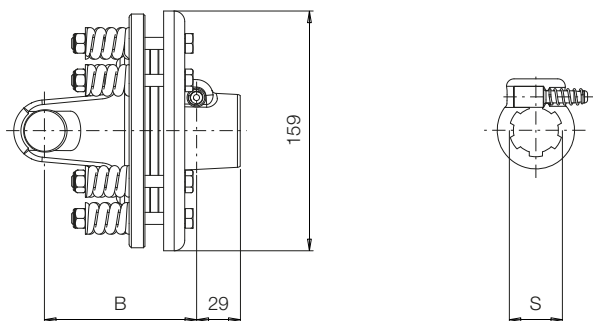

Size	Setting	B (mm)			
	Nm	S = 1 3/8" Z6	1 3/8" Z21	1 3/4" Z6	1 3/4" Z20
4	600	101	101	--	--
	800	101	101	--	--

### FFF22A Driveline codes

Setting					
	Nm	S = 1 3/8" Z6	1 3/8" Z21	1 3/4" Z6	1 3/4" Z20
600		<b>3G0</b>	<b>3G5</b>	--	--
800		<b>3G1</b>	<b>3G6</b>	--	--

### FFF22A Spare part codes

Size	Setting				
	Nm	S = 1 3/8" Z6	1 3/8" Z21	1 3/4" Z6	1 3/4" Z20
4	600	BC670E32A03R	BC670E32A37R	--	--
	800	BC670E39A03R	BC670E39A37R	--	--

 To avoid excessive wear to the implement, driveline, or tractor, Bondioli & Pavesi recommends that the defined setting not be altered.

 All rotating parts must be guarded. The shields on the tractor and on the implement work with the integral driveline guard to form an interactive guarding system.



# Friction torque limiters FFF

FFF22A

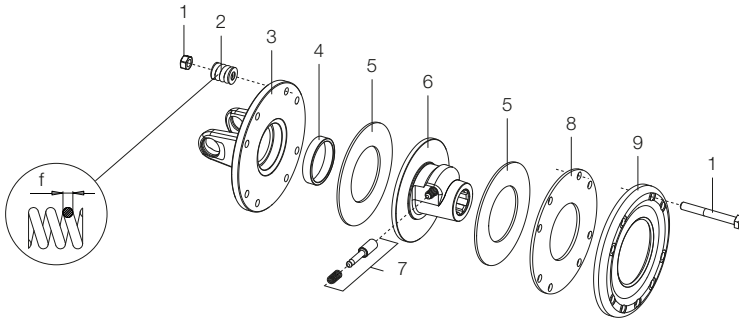

Ref.	Size	Spare part code	Description	Technical notes
1		432000031R08	Bolt	M10 x 75 mm cl 8.8
2		351015001R08	Coil spring	f = 6 mm
3	4	2530E1A05R	Flange yoke	
4		258005320R02	Bushing	
5		247006151R08	Friction lining	D = 124 ; d = 67 mm
6		513850306R 513853706R	Hub with push pin	1 3/8" Z6 1 3/8" Z21
7		403000022R10	Push pin kit	1 3/8" Z6 - Z21
8		2481A0007R02	Inner disc	Sp = 4 mm
9		2481A0006R02	Pressure plate	

The spare part number of the multi-packs ends with a letter "R" and two digits that show the number of units per package.



Friction clutches may become hot.  
Do not touch!  
Keep the area around the friction clutch clear of any material that could catch fire, and avoid prolonged slipping that will generate excess heat and wear

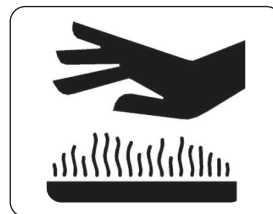

# Friction torque limiters FFF

## FFF32A

with push pin

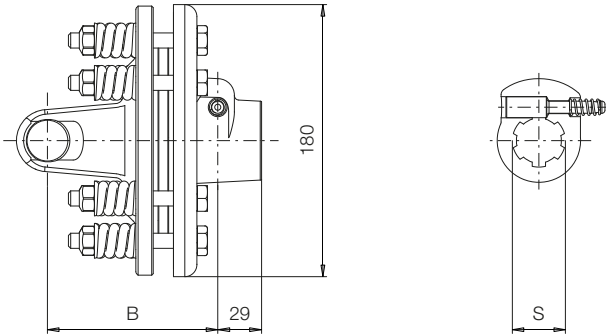

Size	Setting	B (mm)			
	Nm	S = 1 3/8" Z6	1 3/8" Z21	1 3/4" Z6	1 3/4" Z20
4	900	113	113	--	--
5	1100	117	117	--	--
6	1100	125	125	--	--

### FFF32A Driveline codes

Setting					
	Nm	S = 1 3/8" Z6	1 3/8" Z21	1 3/4" Z6	1 3/4" Z20
900		<b>3F0</b>	<b>3F5</b>	--	--
1100		<b>3F2</b>	<b>3F7</b>	--	--

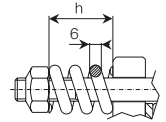

### FFF32A Spare part codes

Size	Setting					h
	Nm	S = 1 3/8" Z6	1 3/8" Z21	1 3/4" Z6	1 3/4" Z20	mm
4	900	BC670E41C03R	BC670E41C37R	--	--	28.8
5	1100	BC670G46C03R	BC670G46C37R	--	--	28.2
6	1100	BC670H46C03R	BC670H46C37R	--	--	28.2



To avoid excessive wear to the implement, driveline, or tractor, Bondioli & Pavesi recommends that the defined setting not to be altered.



All rotating parts must be guarded. The shields on the tractor and on the implement work with the integral driveline guard to form an interactive guarding system.

# Friction torque limiters FFF

**FFF32A**  
with push pin

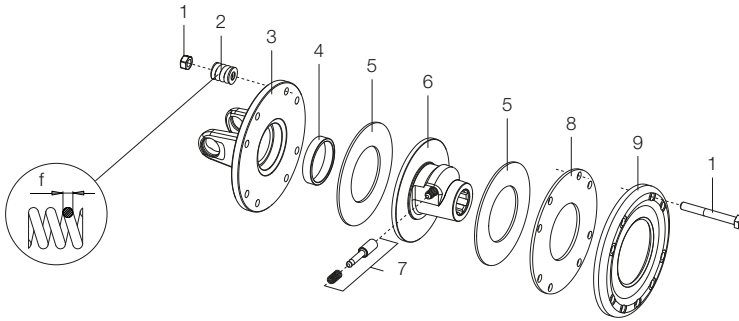

Ref.	Size	Spare part code	Description	Technical notes
1		432000006R08	Bolt	M10 x 85 mm cl 8.8
2		351022370R08	Coil springs	f = 6 mm
3	4	2530E1C05R	Flange yoke	
	5	2530G1C05R		
	6	2530H1C05R		
4		258005320R02	Bushing	
5		247006251R08	Friction lining	D = 141 ; d = 77 mm
6		513860302R 513863701R	Hub with push pin	1 3/8" Z6 1 3/8" Z21
7		403000002R10	Push pin kit	1 3/8" Z6 - Z21
8		2481C0007R02	Inner disc	Sp = 4 mm
9		248220007R02	Pressure plate	

The spare part number of the multi-packs ends with a letter "R" and two digits that show the number of units per package.



Friction clutches may become hot.

Do not touch!

Keep the area around the friction clutch clear of any material that could catch fire, and avoid prolonged slipping that will generate excess heat and wear

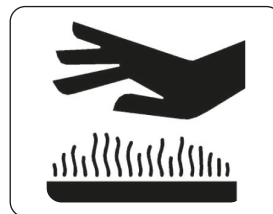

# Friction torque limiters FFF

## FFF32A

with taper pin

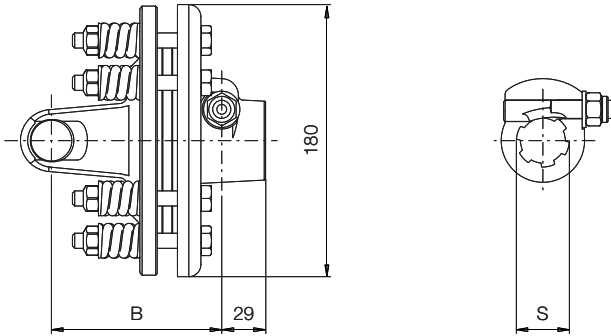

Size	Setting	B (mm)			
	Nm	S = 1 3/8" Z6	1 3/8" Z21	1 3/4" Z6	1 3/4" Z20
4	900	113	113	--	--
	1100	117	117	--	--
6	900	125	125	--	--
	1100	125	125	--	--

### FFF32A Driveline codes

Setting	S = 1 3/8" Z6			
	Nm	1 3/8" Z21	1 3/4" Z6	1 3/4" Z20
900	<b>2R0</b>	<b>2R5</b>	--	--
1100	<b>2R2</b>	<b>2R7</b>	--	--

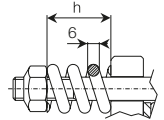

### FFF32A Spare part codes

Size	Setting					h
	Nm	S = 1 3/8" Z6	1 3/8" Z21	1 3/4" Z6	1 3/4" Z20	mm
4	900	BC670E41203R	BC670E41237R	--	--	28.8
	1100	BC670G46203R	BC670G46237R	--	--	28.2
6	900	BC670H41203R	BC670H41237R	--	--	28.8
	1100	BC670H46203R	BC670H46237R	--	--	28.2



To avoid excessive wear to the implement, driveline, or tractor, Bondioli & Pavesi recommends that the defined setting not be altered.



All rotating parts must be guarded. The shields on the tractor and on the implement work with the integral driveline guard to form an interactive guarding system.

# Friction torque limiters FFF

**FFF32A**  
with taper pin

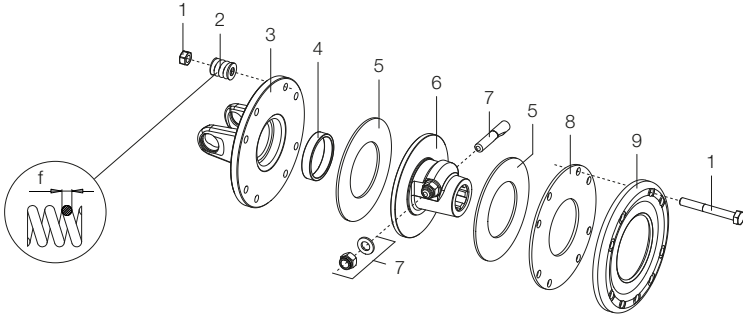

Ref.	Size	Spare part code	Description	Technical notes
1		432000006R08	Bolt	M10 x 85 mm cl 8.8
2		351022370R08	Coil springs	f = 6 mm
3	4	2530E1C05R	Flange yoke	
	5	2530G1C05R		
	6	2530H1C05R		
4		258005320R02	Bushing	
5		247006251R08	Friction lining	D = 141 ; d = 77 mm
6		515860304R 515863704R	Hub with push pin	1 3/8" Z6 1 3/8" Z21
7		408000047R02	Push pin kit	1 3/8" Z6 - Z21
8		2481C0007R02	Inner disc	Sp = 4 mm
9		248220007R02	Pressure plate	

The spare part number of the multi-packs ends with a letter "R" and two digits that show the number of units per package.



Friction clutches may become hot.

Do not touch!

Keep the area around the friction clutch clear of any material that could catch fire, and avoid prolonged slipping that will generate excess heat and wear

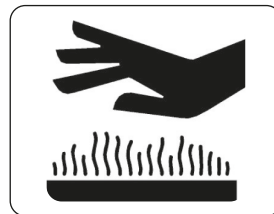

# Friction torque limiters FFF

## FFF42A

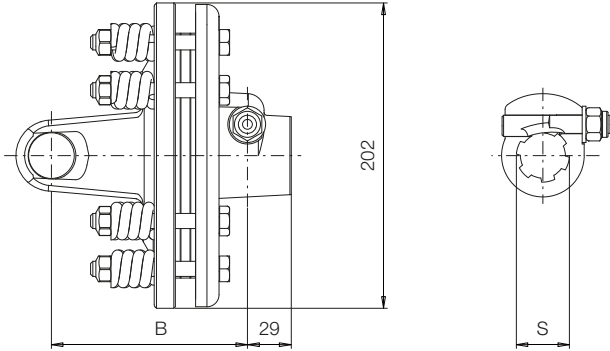

Size	Setting	B (mm)			
	Nm	S = 1 3/8" Z6	1 3/8" Z21	1 3/4" Z6	1 3/4" Z20
6	1200	130	130	130	130
	1350	130	130	130	130
	1450	130	130	130	130

### FFF42A Driveline codes

Setting				
Nm	S = 1 3/8" Z6	1 3/8" Z21	1 3/4" Z6	1 3/4" Z20
1200	<b>2V8</b>	<b>2W4</b>	<b>2X0</b>	<b>2X6</b>
1350	<b>2V9</b>	<b>2W5</b>	<b>2X1</b>	<b>2X7</b>
1450	<b>2W0</b>	<b>2W6</b>	<b>2X2</b>	<b>2X8</b>

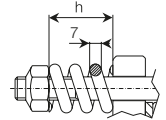

### FFF42A Spare part codes

Size	Setting					h
	Nm	S = 1 3/8" Z6	1 3/8" Z21	1 3/4" Z6	1 3/4" Z20	mm
6	1200	BC670H48403R	BC670H48437R	BC670H48404R	BC670H48438R	29.5
	1350	BC670H51403R	BC670H48437R	BC670H48404R	BC670H48438R	29.3
	1450	BC670H53403R	BC670H53437R	BC670H53404R	BC670H53438R	29.2

 To avoid excessive wear to the implement, driveline, or tractor, Bondioli & Pavesi recommends that the defined setting not to be altered.

 All rotating parts must be guarded. The shields on the tractor and on the implement work with the integral driveline guard to form an interactive guarding system.

# Friction torque limiters FFF

FFF42A

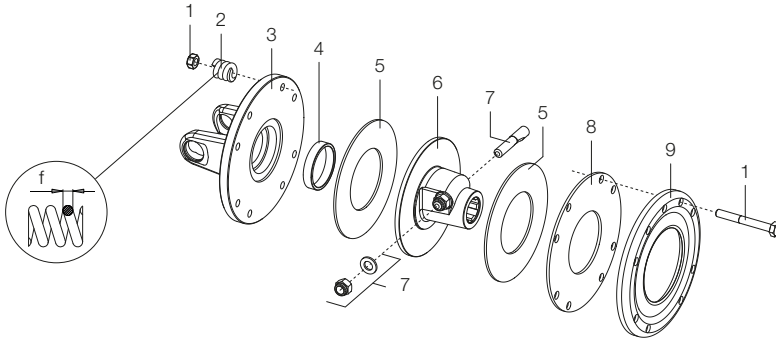

Ref.	Size	Spare part code	Description	Technical notes
1		432000006R08	Bolt	M10 x 85 mm cl 8.8
2		351013370R08	Coil springs	f = 7 mm
3	6	2530H1E05R	Flange yoke	
4		258005320R02	Bushing	
5		247006311R08	Friction lining	D = 162 ; d = 85 mm
6		515870304R 515873704R 515870404R 515873804R	Hub with taper pin	1 3/8" Z6 1 3/8" Z21 1 3/4" Z6 1 3/4" Z20
7		408000047R02 408000046R02	Taper pin kit	1 3/8" Z6 - Z21 1 3/4" Z6 - Z20
8		2481E0007R02	Inner disc	Sp = 4 mm
9		248230006R02	Pressure plate	

The spare part number of the multi-packs ends with a letter "R" and two digits that show the number of units per package.



Friction clutches may become hot.

Do not touch!

Keep the area around the friction clutch clear of any material that could catch fire, and avoid prolonged slipping that will generate excess heat and wear

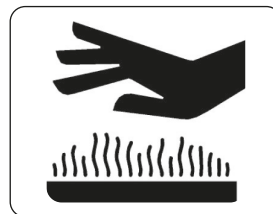

# Friction torque limiters FFF

## FFF34A

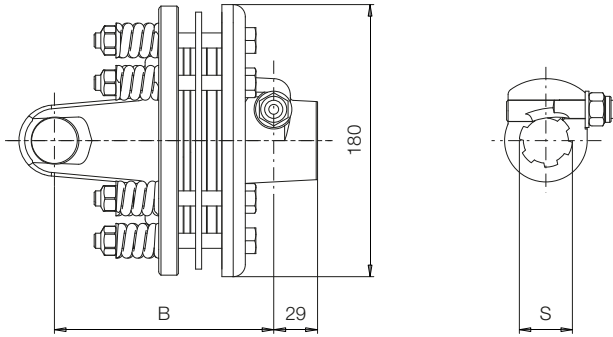

Size	Setting	B (mm)			
	Nm	S = 1 3/8" Z6	1 3/8" Z21	1 3/4" Z6	1 3/4" Z20
6	1200	140	140	145	145
	1350	140	140	145	145
	1450	140	140	145	145

### FFF34A Driveline codes

Setting	B (mm)				
	Nm	S = 1 3/8" Z6	1 3/8" Z21	1 3/4" Z6	1 3/4" Z20
1200	<b>2S0</b>	--	--	--	--
1350	<b>2S1</b>	--	--	--	<b>2V2</b>
1450	<b>2S2</b>	<b>2S9</b>	<b>2T6</b>	<b>2V3</b>	

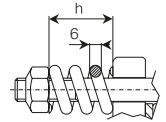

### FFF34A Spare part codes

Size	Setting	B (mm)				h
	Nm	S = 1 3/8" Z6	1 3/8" Z21	1 3/4" Z6	1 3/4" Z20	mm
6	1200	BC670H48303R	--	--	--	29.5
	1350	BC670H51303R	--	--	BC670H51338R	29.2
	1450	BC670H53303R	BC670H53337R	BC670H53304R	BC670H53338R	29.0

 To avoid excessive wear to the implement, driveline, or tractor, Bondioli & Pavesi recommends that the defined setting not be altered.

 All rotating parts must be guarded. The shields on the tractor and on the implement work with the integral driveline guard to form an interactive guarding system.



# Friction torque limiters FFF

FFF34A

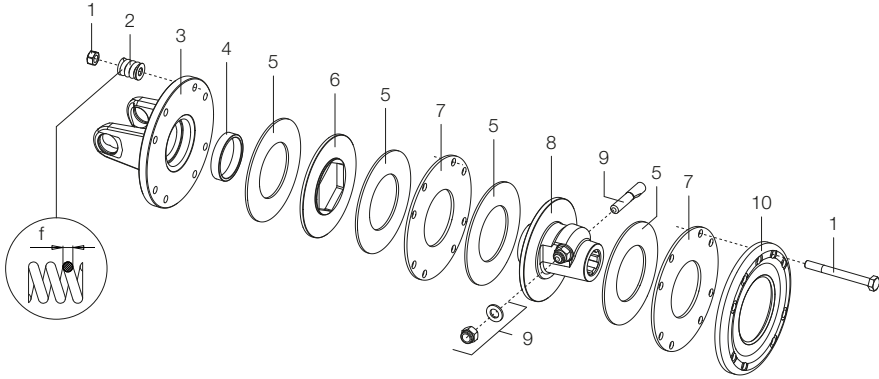

Ref.	Size	Spare part code	Description	Technical notes
1		43200007R08	Bolt	M10 x 100 mm cl 8.8
2		351022370R08	Coil springs	f = 6 mm
3	6	2530H1C05R	Flange yoke	
4		258005320R02	Bushing	
5		247006251R08	Friction lining	D = 141 ; d = 77 mm
6		248727701R02	Driving disc	
7		2481C0007R02	Inner disc	Sp = 4 mm
8		515890305R 515893705R 515890404R 515893804R	Hub with taper pin	1 3/8" Z6 1 3/8" Z21 1 3/4" Z6 1 3/4" Z20
9		408000047R02 408000049R02	Taper pin kit	1 3/8" Z6 - Z21 1 3/4" Z6 - Z20
10		248220007R02	Pressure plate	

The spare part number of the multi-packs ends with a letter "R" and two digits that show the number of units per package.



Friction clutches may become hot.

Do not touch!

Keep the area around the friction clutch clear of any material that could catch fire, and avoid prolonged slipping that will generate excess heat and wear

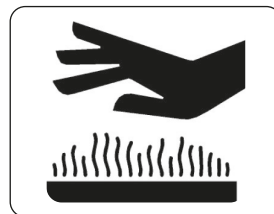

# Friction torque limiters FFF

## FV44

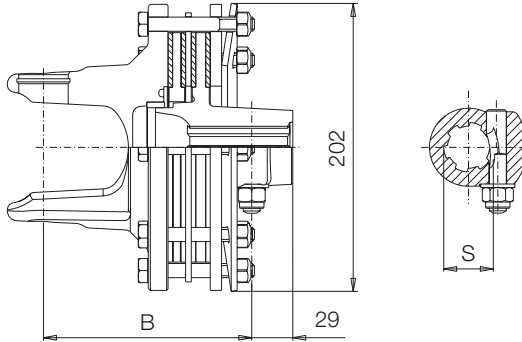

Size	Setting	B (mm)			
	Nm	S = 1 3/8" Z6	1 3/8" Z21	1 3/4" Z6	1 3/4" Z20
<b>G9</b>	2200	--	--	--	154

### FV44 Driveline codes

Setting	B (mm)				
	Nm	S = 1 3/8" Z6	1 3/8" Z21	1 3/4" Z6	1 3/4" Z20
2200	--	--	--	<b>N83</b>	

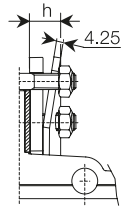

### FV44 Spare part codes

Size	Setting	B (mm)				h
	Nm	S = 1 3/8" Z6	1 3/8" Z21	1 3/4" Z6	1 3/4" Z20	mm
<b>G9</b>	2200	--	--	--	BC661M62538R	18.6

 To avoid excessive wear to the implement, driveline, or tractor, Bondioli & Pavesi recommends that the defined setting not to be altered.

 All rotating parts must be guarded. The shields on the tractor and on the implement work with the integral driveline guard to form an interactive guarding system.

# Friction torque limiters FFF

FV44

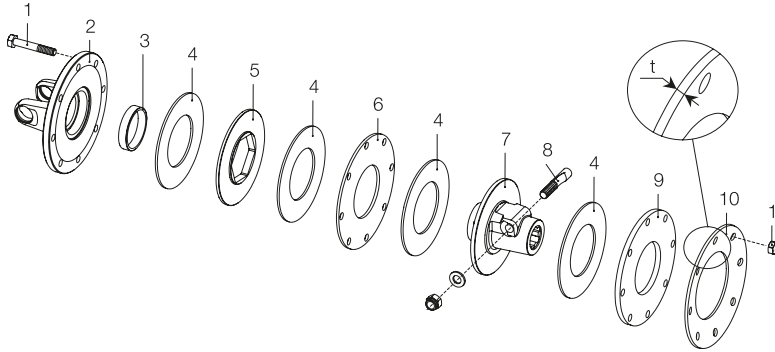

Ref.	Size	Spare part code	Description	Technical notes
1		432000114R08	Bolt	M10 x 75 mm cl 8.8
2	<b>G9</b>	253089001R	Flange yoke	
3		258005320R02	Bushing	
4		247006351R08	Friction lining	D = 162 ; d = 85 mm
5		248737702R02	Driving disc	
6		248870011R02	Inner disc	Thickness = 4 mm
7		515903805R	Hub with taper pin	
8		408000046R02	Taper pin kit	1 3/4" Z20
9		248870007R	Pressure plate	Thickness = 8 mm
10		367009870R	Belleville spring	t = 4.25 mm

The spare part number of the multi-packs ends with a letter "R" and two digits that show the number of units per package.



Friction clutches may become hot.

Do not touch!

Keep the area around the friction clutch clear of any material that could catch fire, and avoid prolonged slipping that will generate excess heat and wear

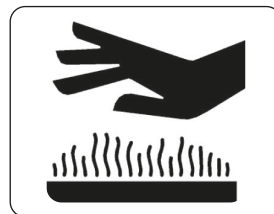

# Lubrication

Lubrication frequency (hours) and estimated grease volumes



Size: 1

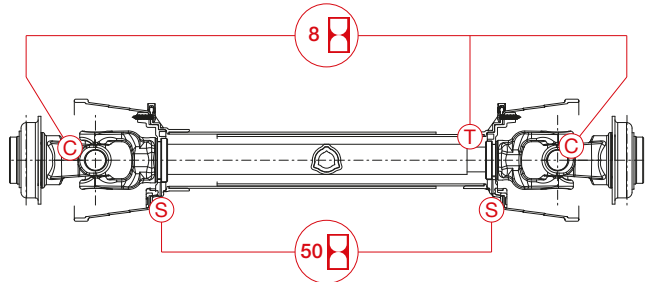

Size: 2 - 4 - 5 - 6  
50 h BP Italy Cross Kits  
8 h BP China Cross Kits

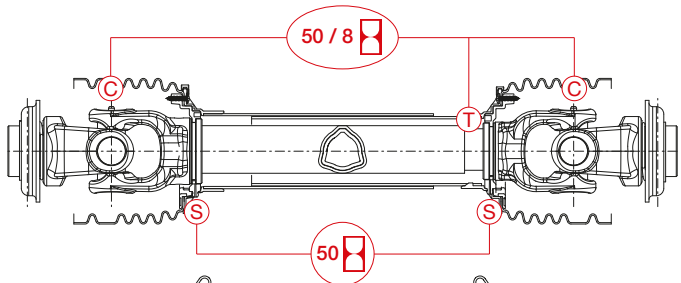

Size: G9

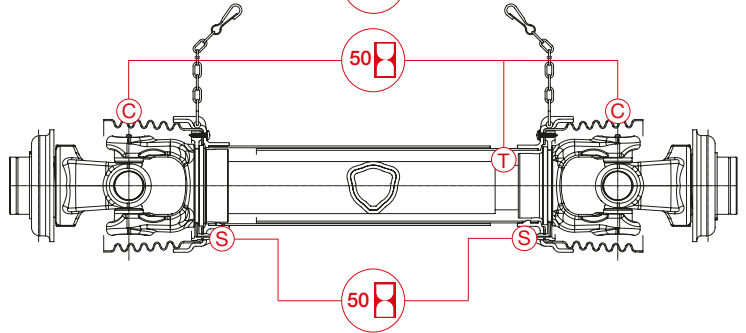

	1	2	3	4	5	6	G9
Crosses <b>(C)</b>	4 g	7 g	10 g	13 g	18 g	26 g	
Shields <b>(S)</b>				6 g			
Telescoping members <b>(T)</b>	12 g	20 g					32 g

# Lubrication

---

RA1 and RA2 Overrunning clutches

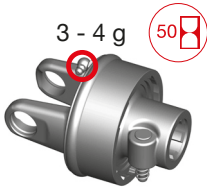

LB Shear bolt torque limiter

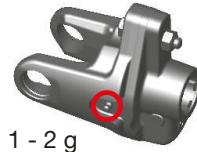







**BONDIOLI & PAVESI HYDRAULIC AND MECHANICAL COMPONENT (HANGZHOU) CO. LTD**  
N°420 of Beitang East Road, Xinjie Town, Xiaoshan District, HANGZHOU CITY, 311217 Zhejiang Province  
Tel.: (0571) 83508180 -Telefax (0571) 83508178 - 83508177 - E-mail [customer\\_service@bypychina.com](mailto:customer_service@bypychina.com)  
[www.bondioli-pavesi.com](http://www.bondioli-pavesi.com)